

Mini Series

Crack Yak mini
MXS-C mini
Edge 540 mini



V1.0

Kit Contents:

- *Fuselage
- *Wings
- *Backbone
- *Horizontal Stab
- *Vertical Stab
- *SFG's

- *Landing gear
- *Accessory Pack
- *Carbon reinforcements:
 - 2x- $\varnothing 0,8 \times 330$... Stabs pushrods
 - 2x- $3 \times 0,5 \times 500$... Wing spar (Variant A)
 - $5 \times 0,6 \times 500$... Wing spar (Variant B)

Accessory Pack Contents:

- 6x Plastic clevises
- 1x Heatshrink tube
- 4x Adjustable link+quicklock washer
- 1x Plastic frame
- 10x Elevator/rudder pushrod leads

- 2x Carbon $3(4) \times 0,5 \times 150$... Landing gear
- 2x Carbon $\varnothing 1 \times 125$... Aileron pushrod
- Carbon $3 \times 0,5 \times 100$... Elevator reinforcement

Plastic frame:

1. Aileron servo horn
2. Aileron horns
3. Elevator horn
4. Rudder horn
5. Motor mount
6. Landing gear parts

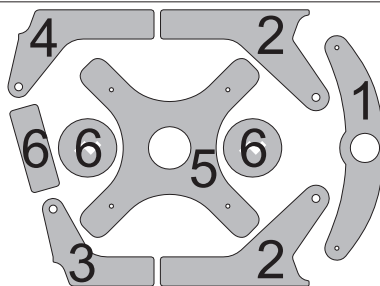

You Will Also Need:

- * CA medium+thin, CA kicker
- * Sharp hobby knife
- * Screwdriver
- * Pliers

- * Ruler
- * Sandpaper 100-500
- * Thread

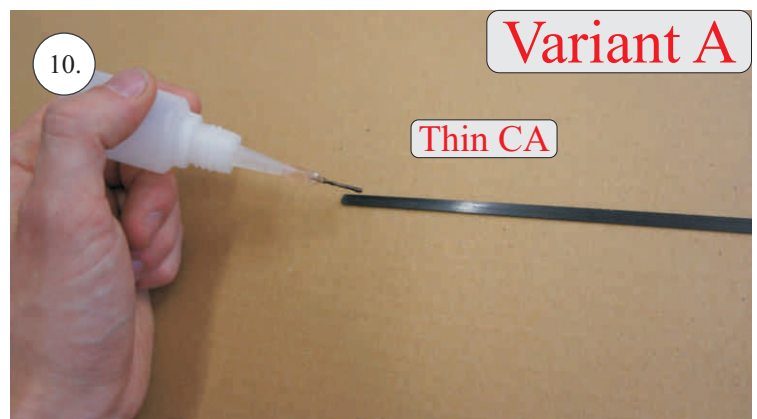
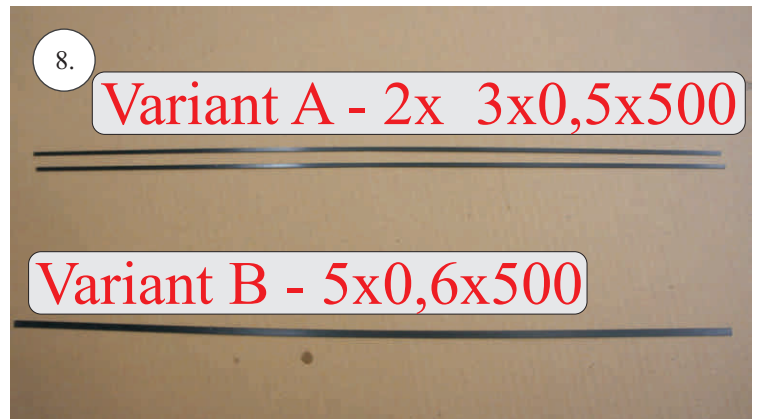
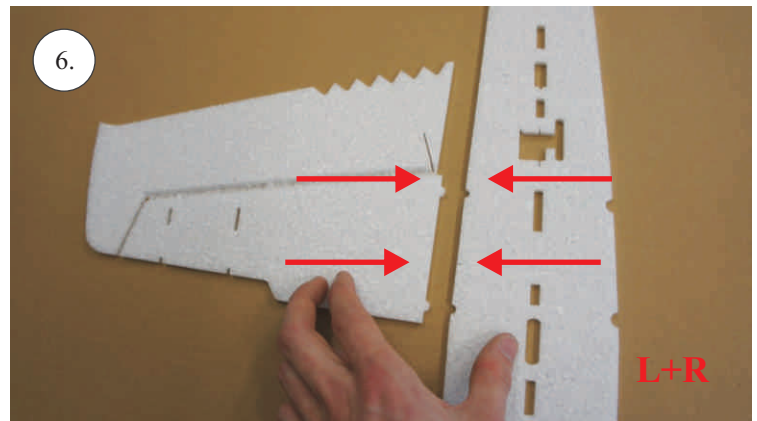
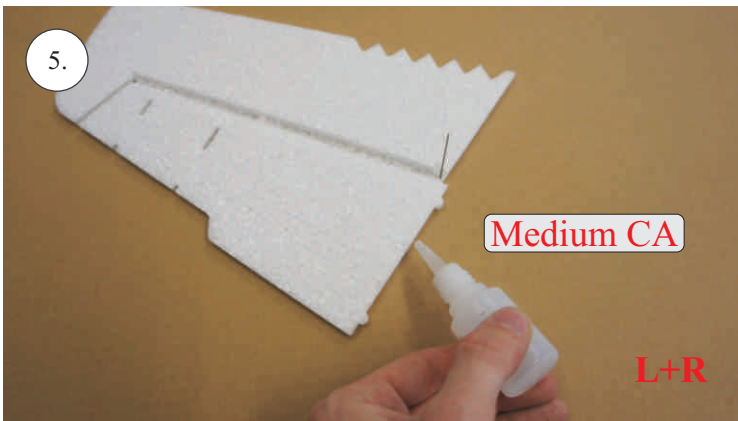
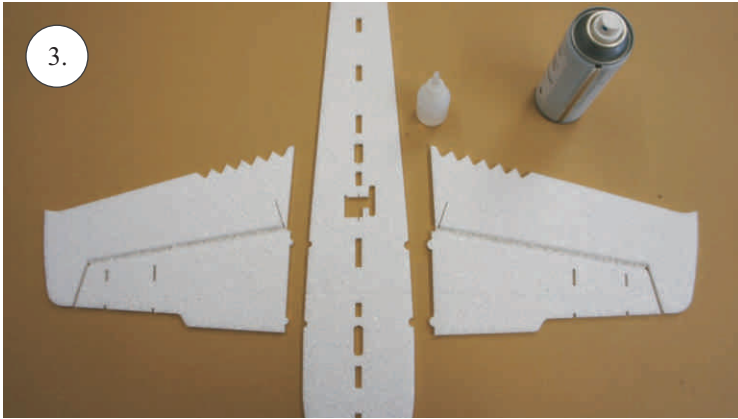
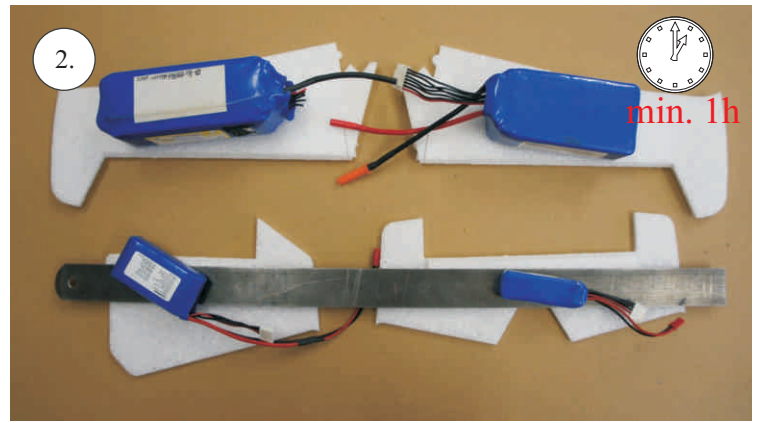
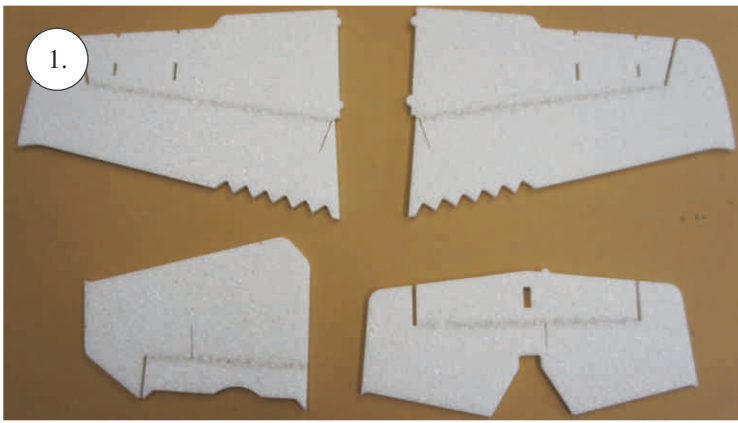

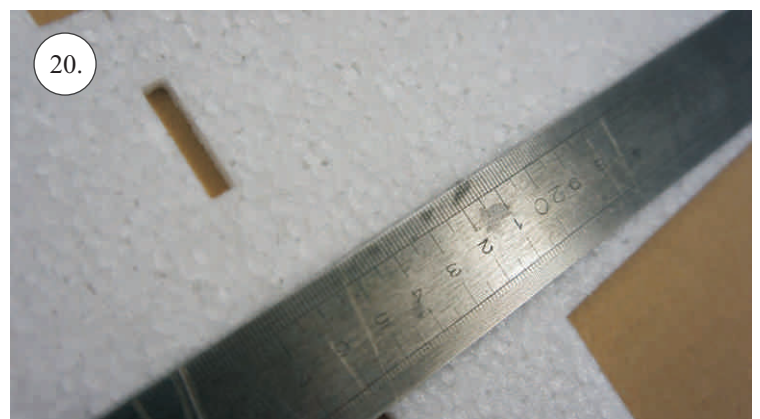
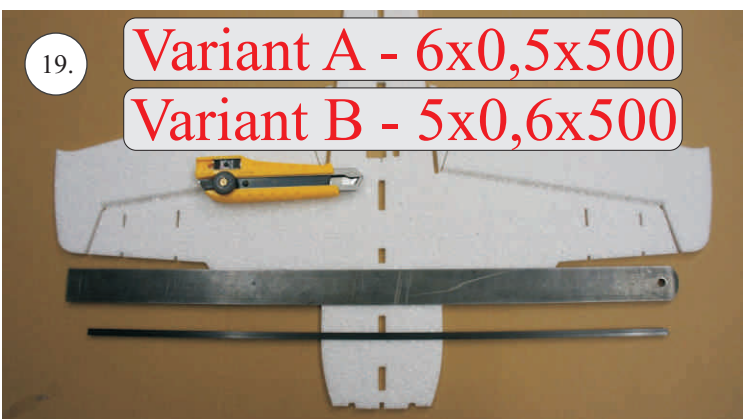
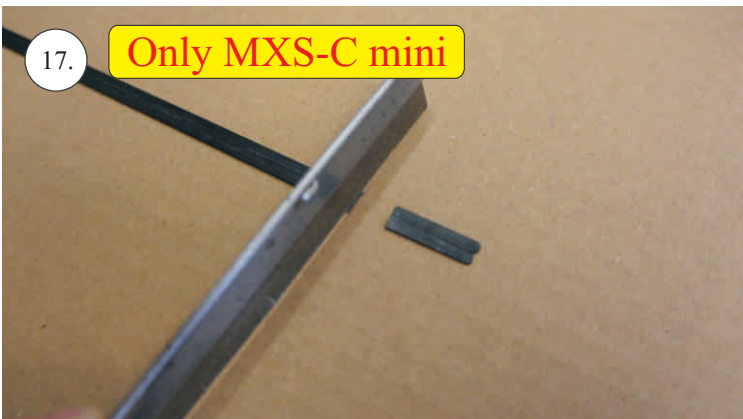
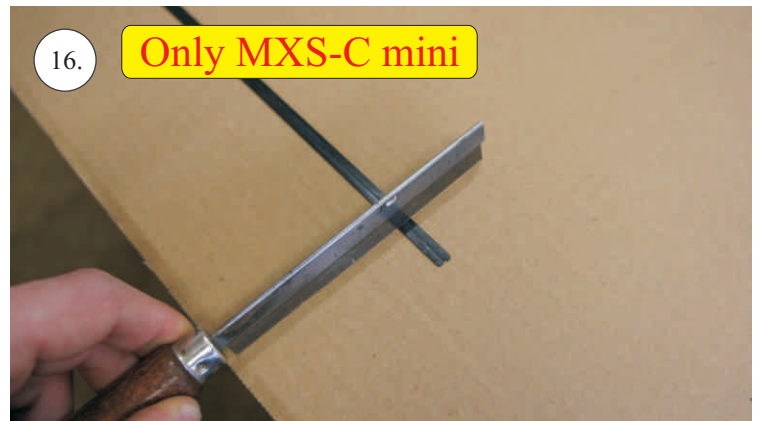
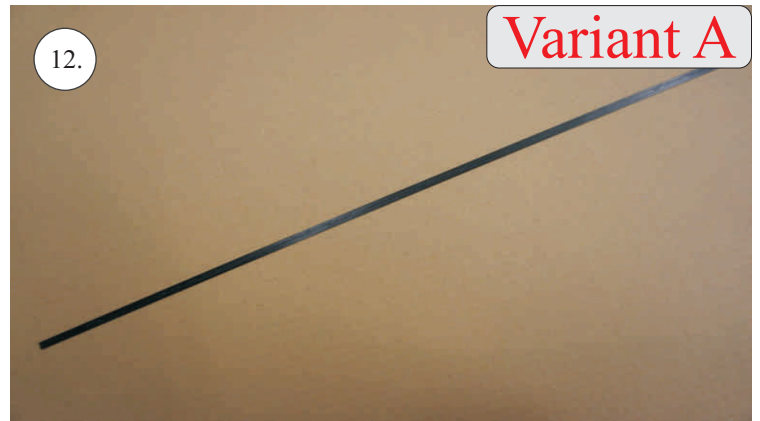

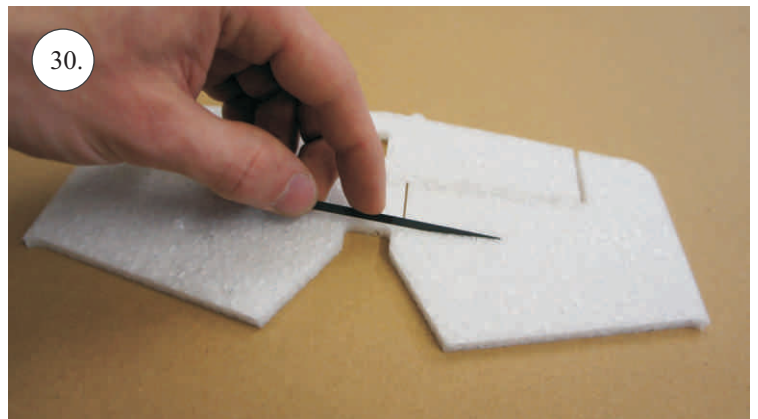
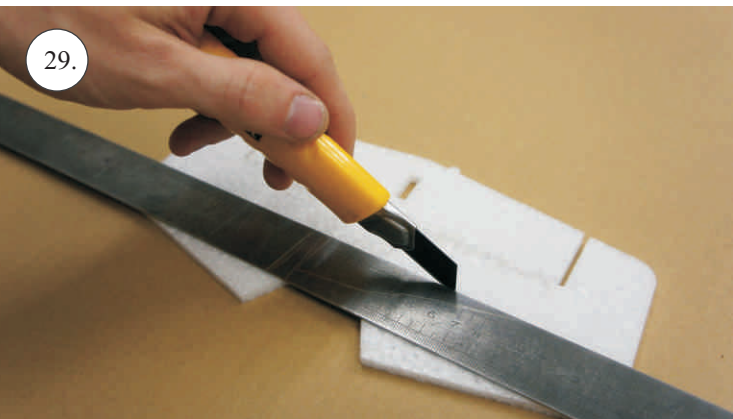
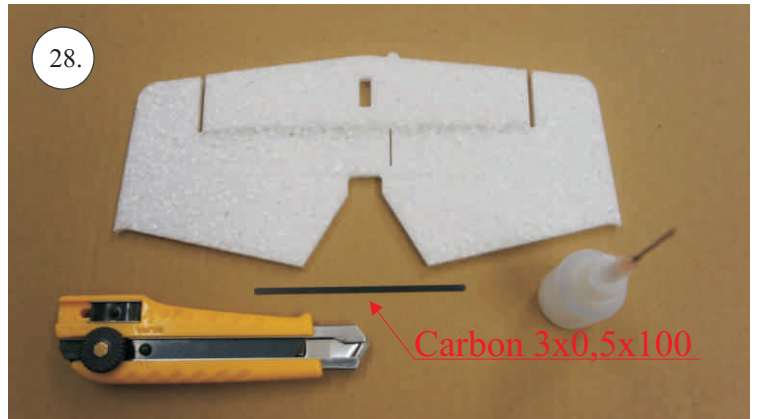
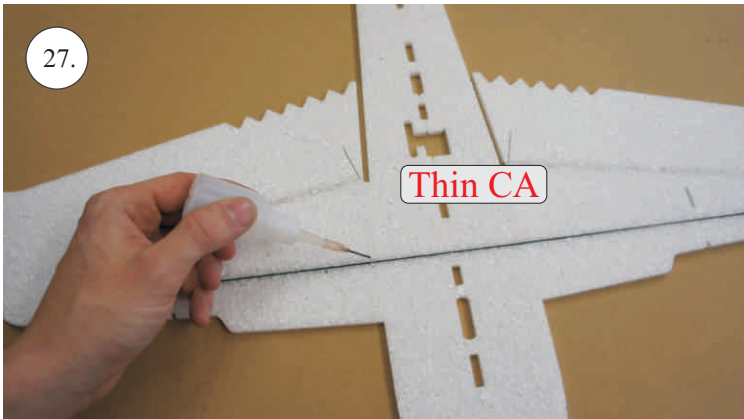
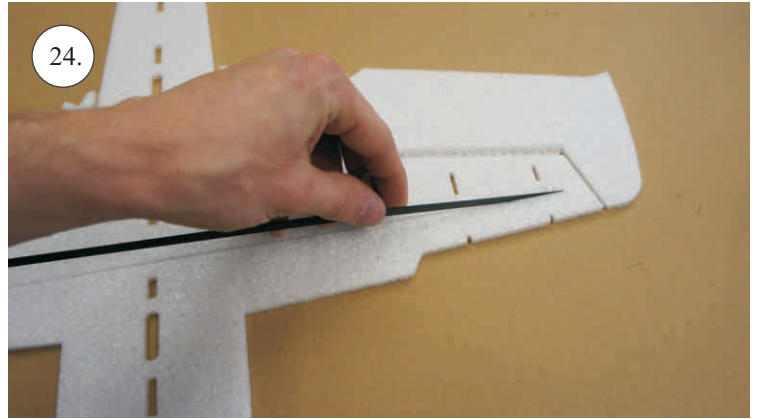
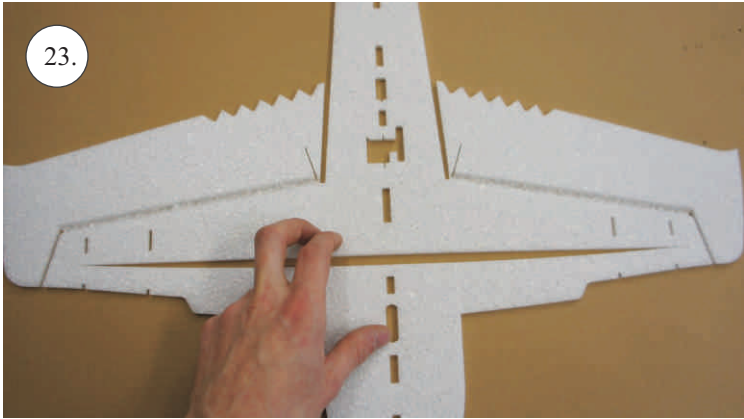
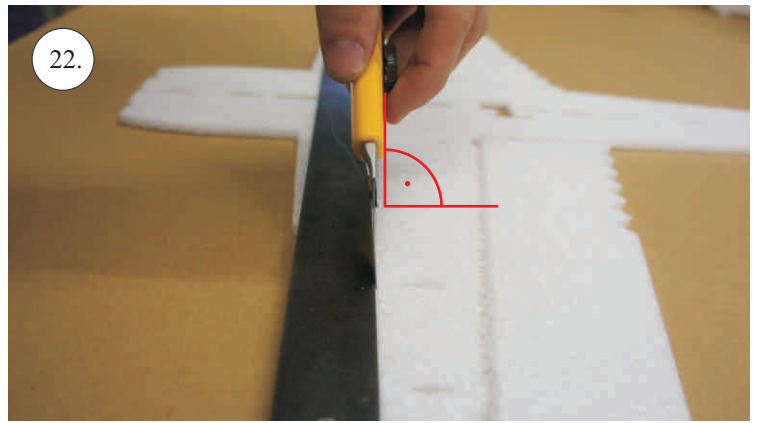
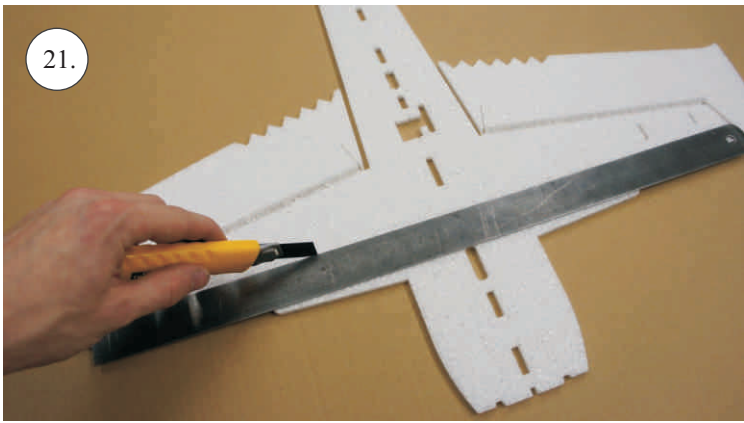

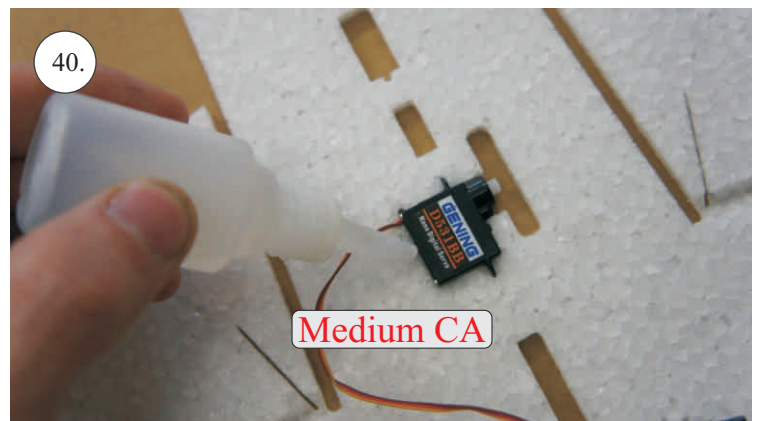
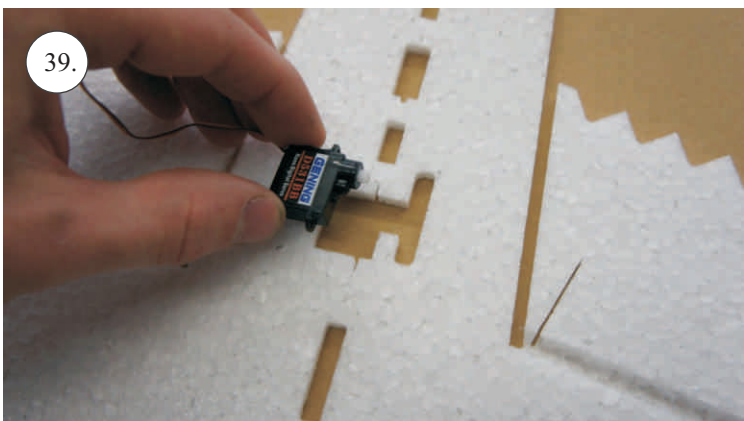
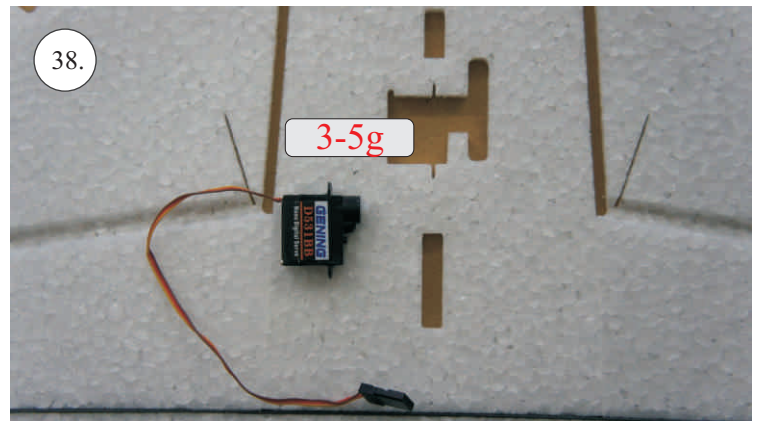
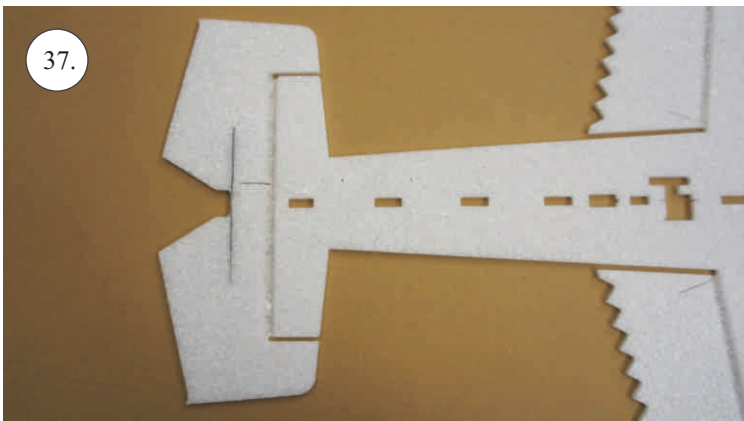
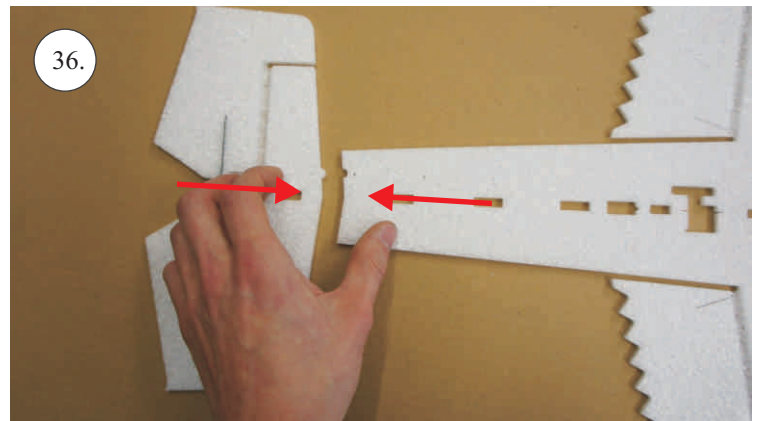
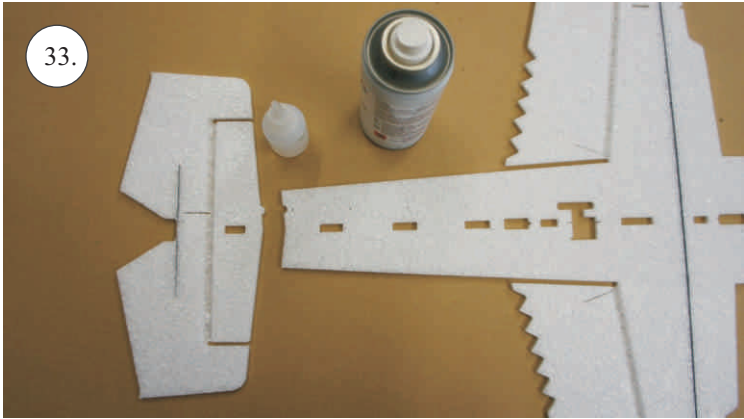
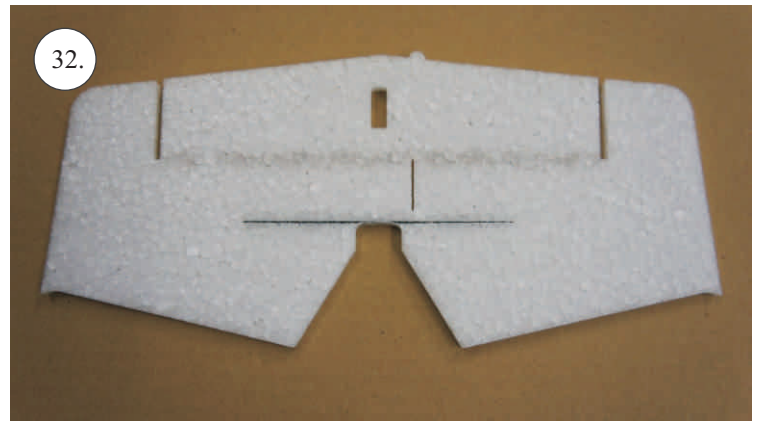
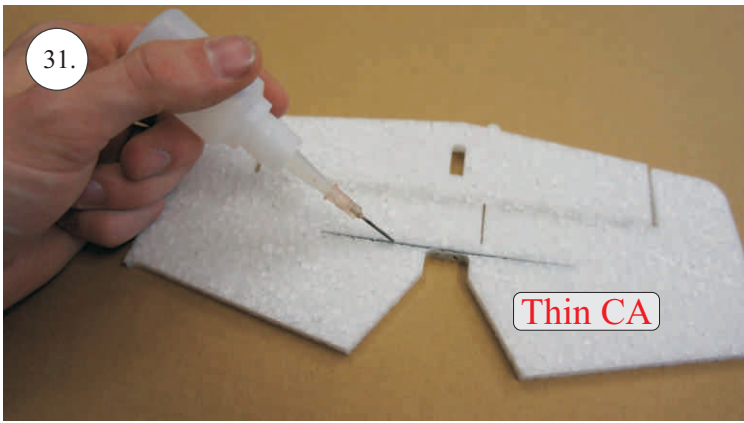

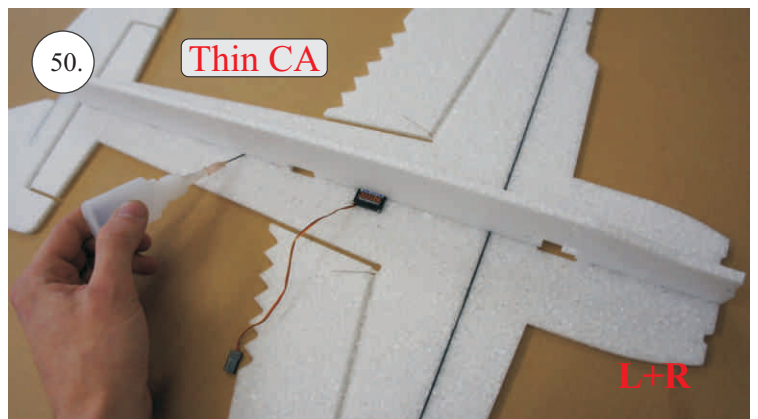
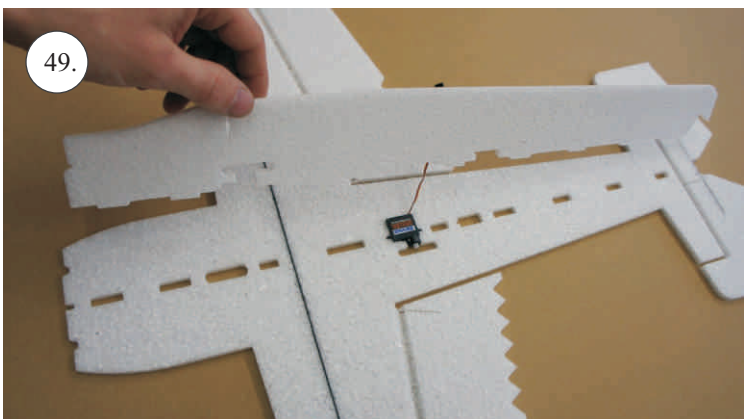
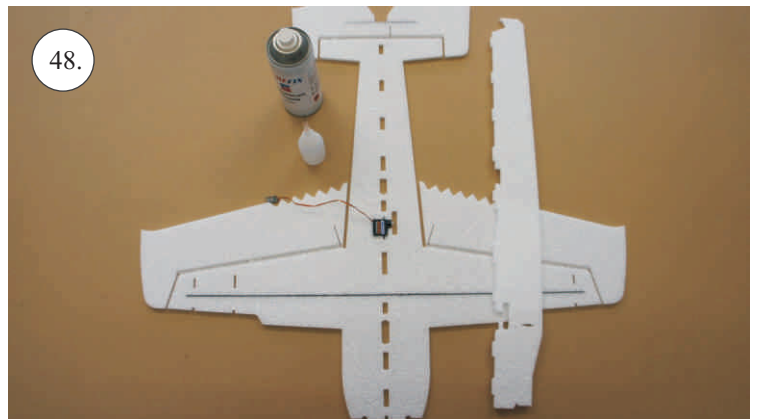
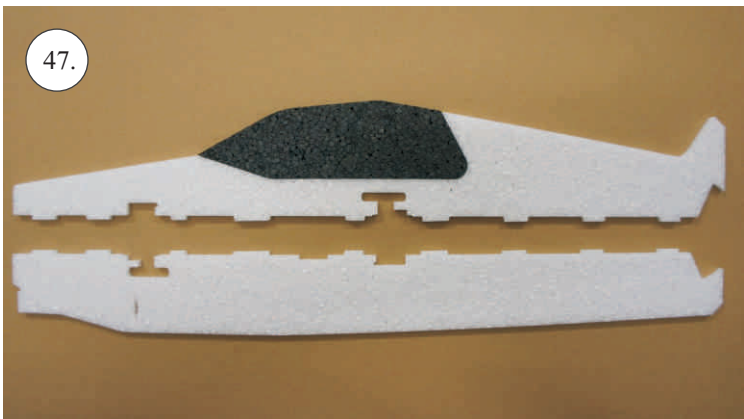
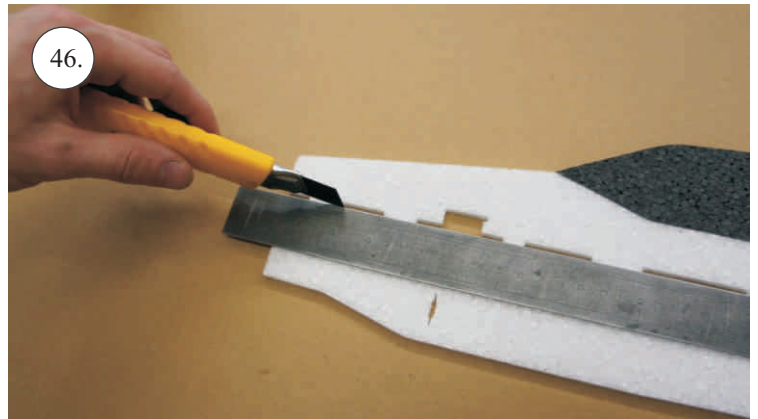
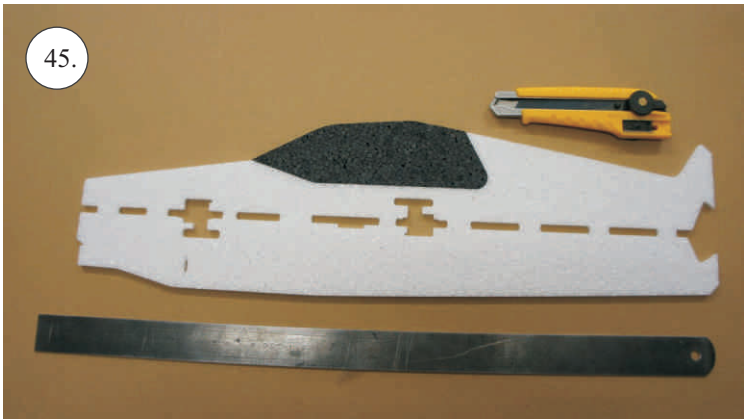
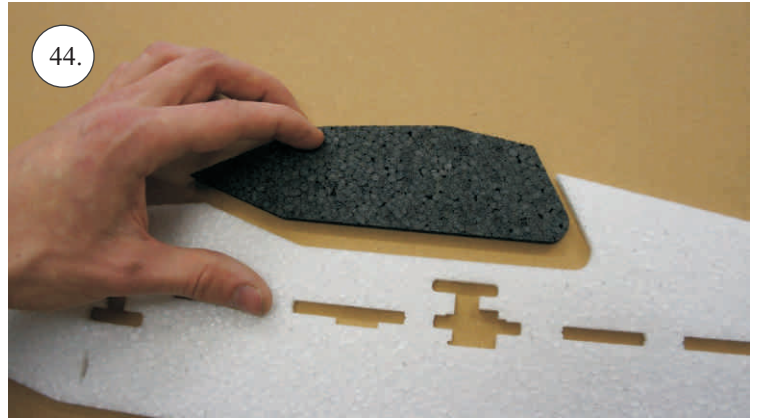
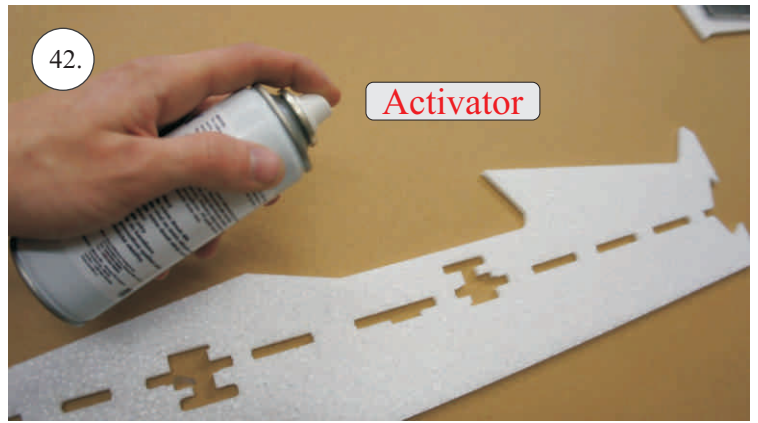
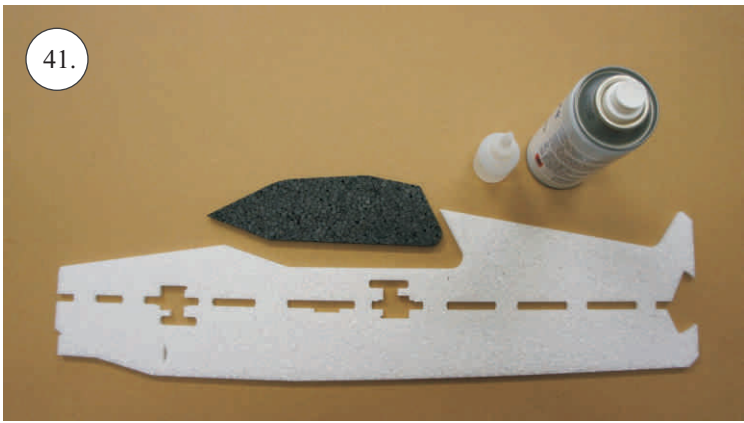

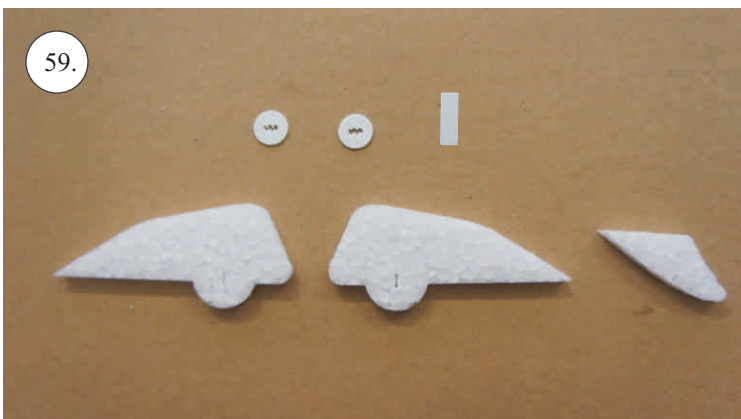
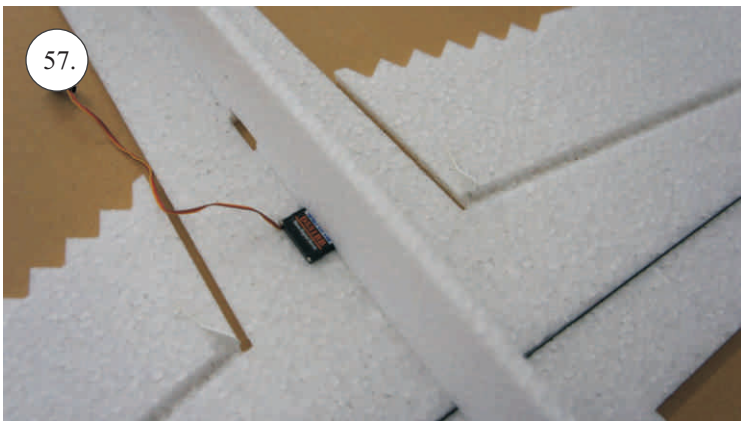
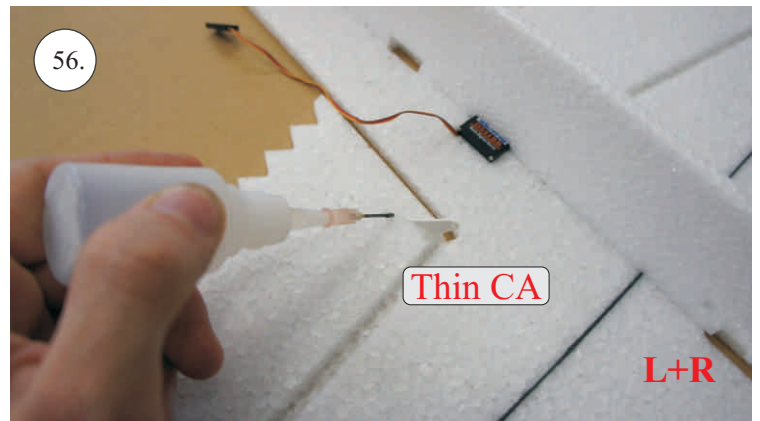
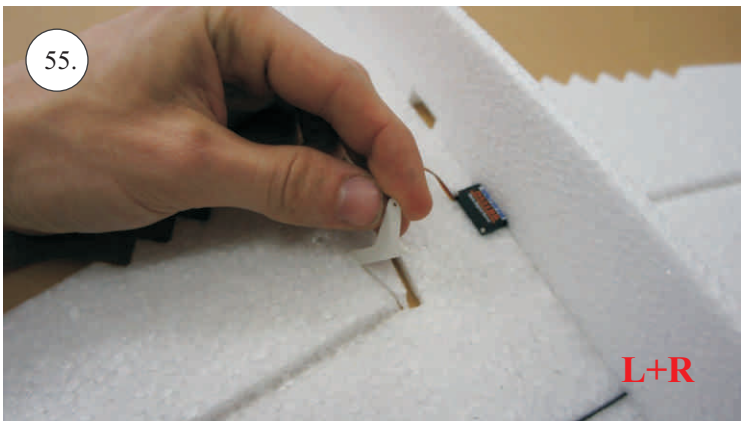
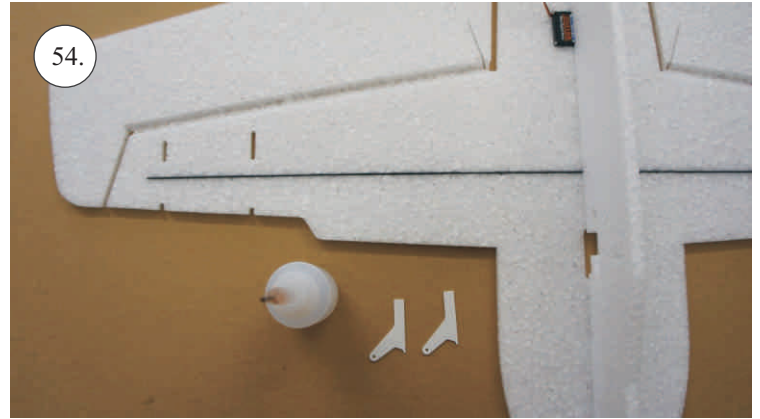
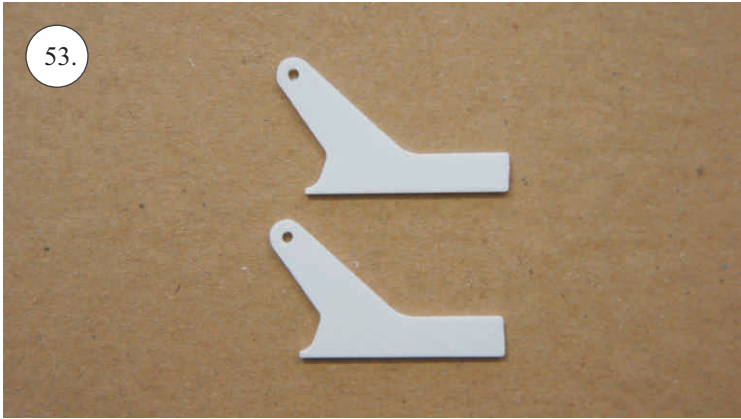
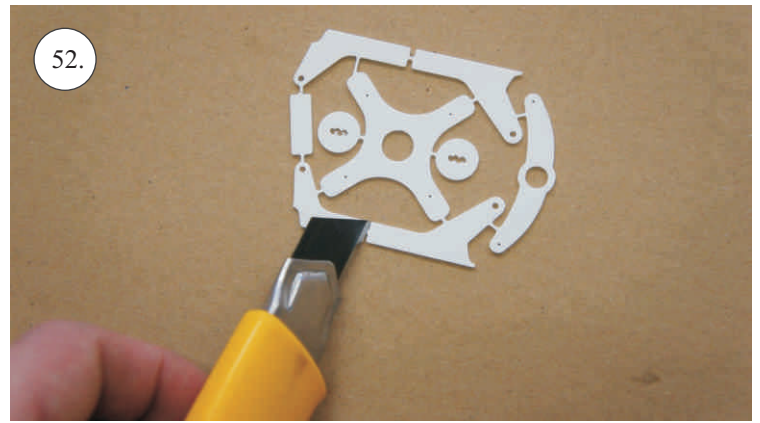
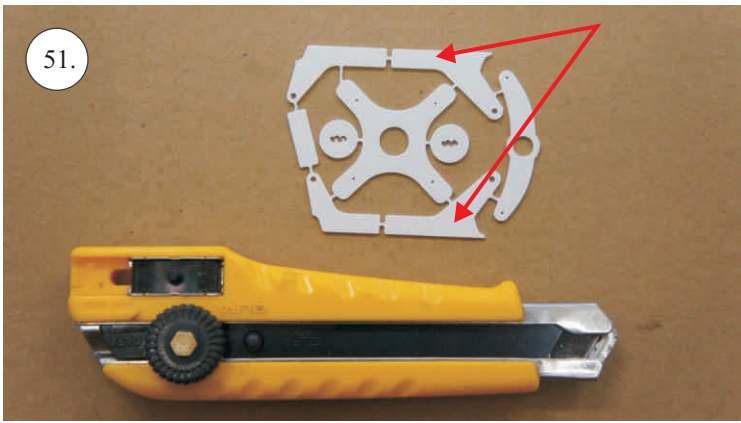

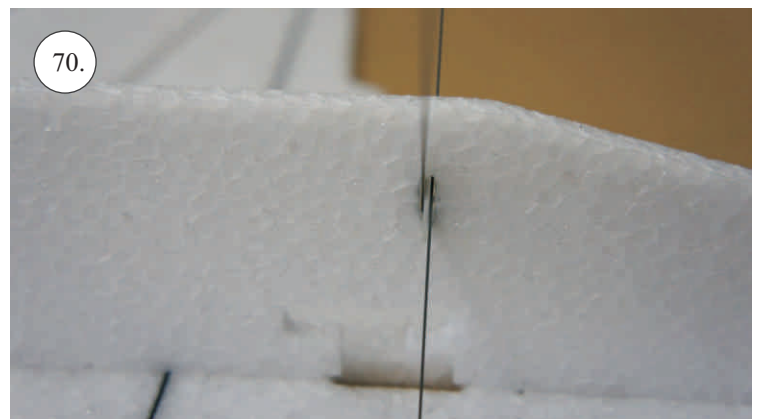
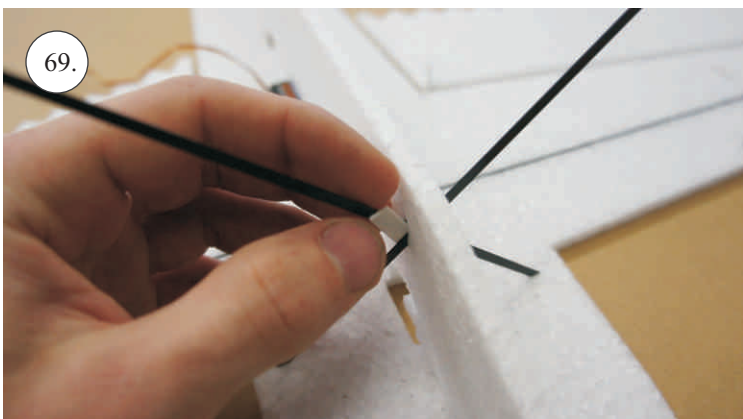
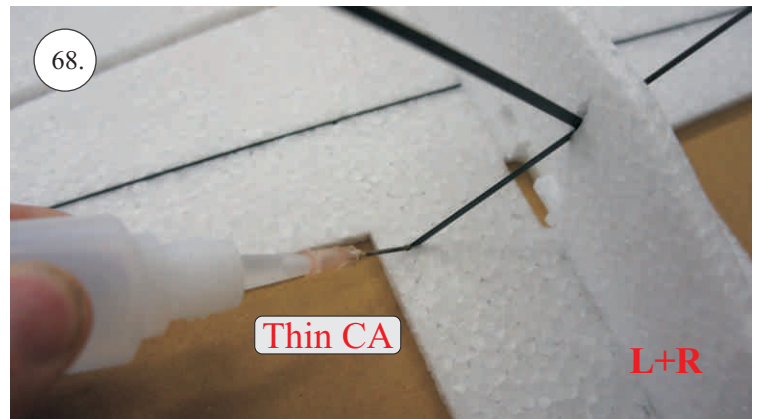
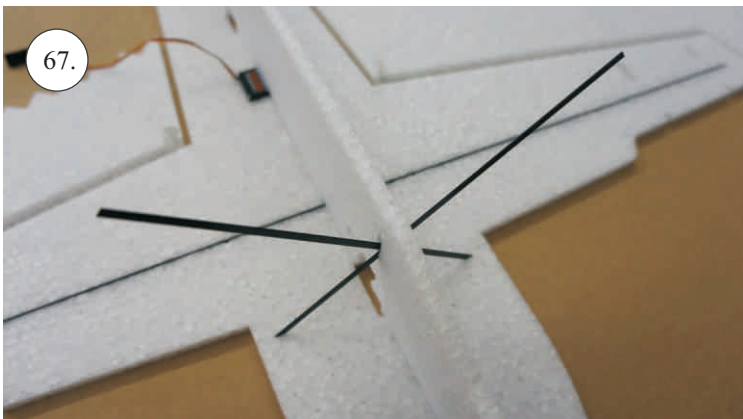
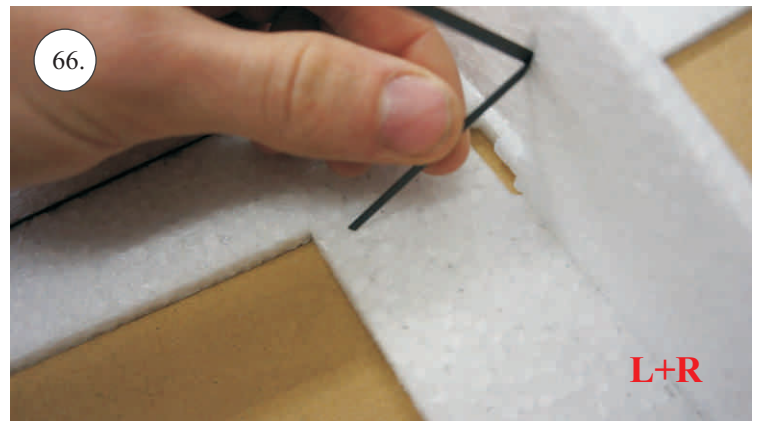
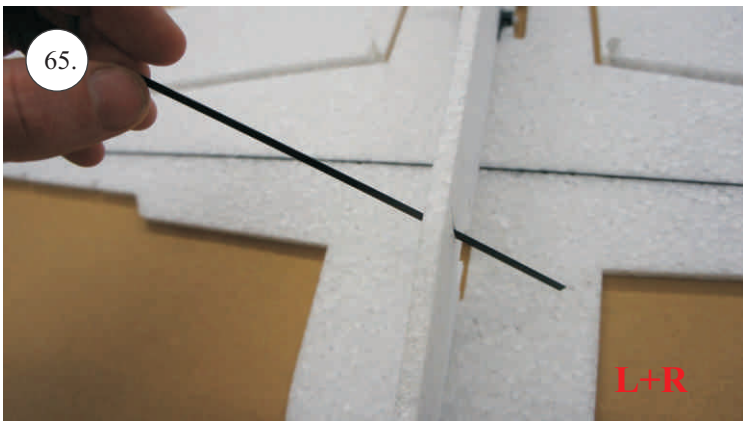
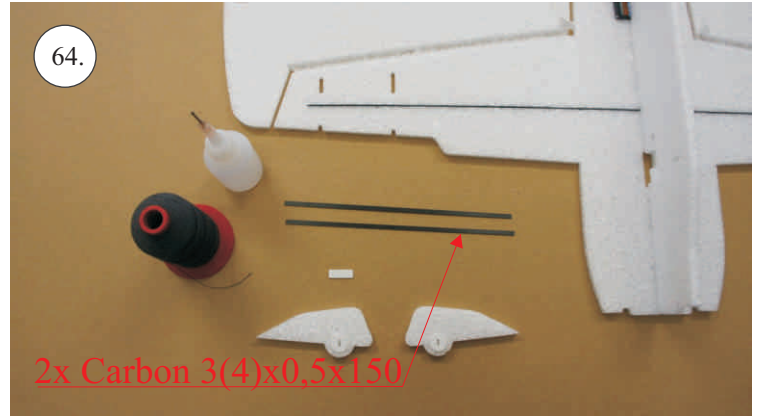
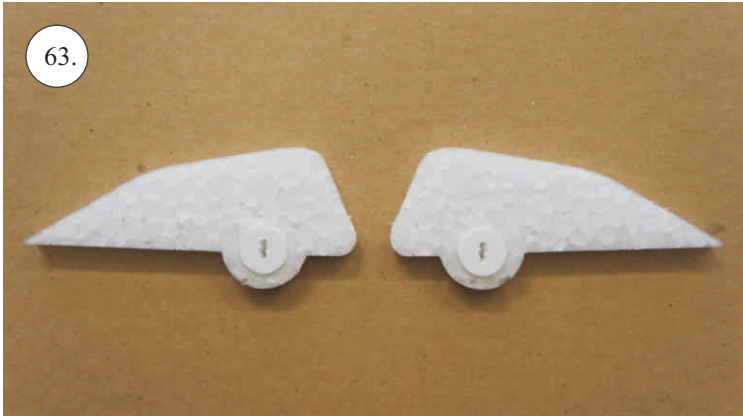
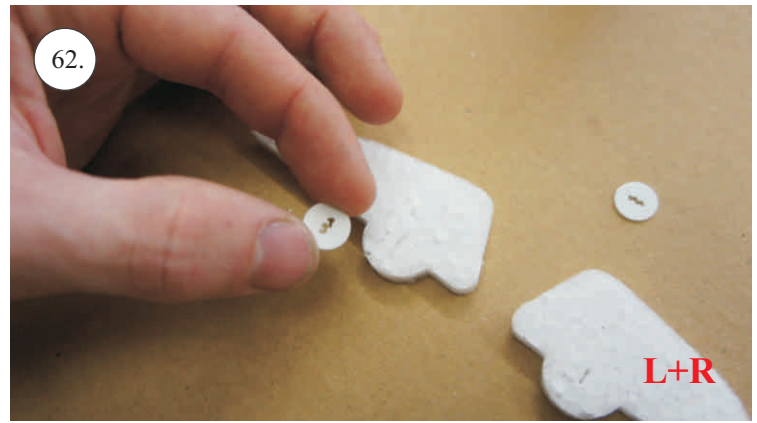
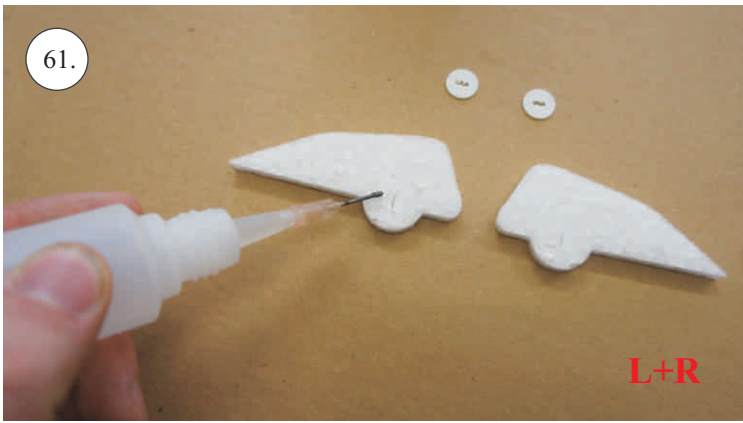

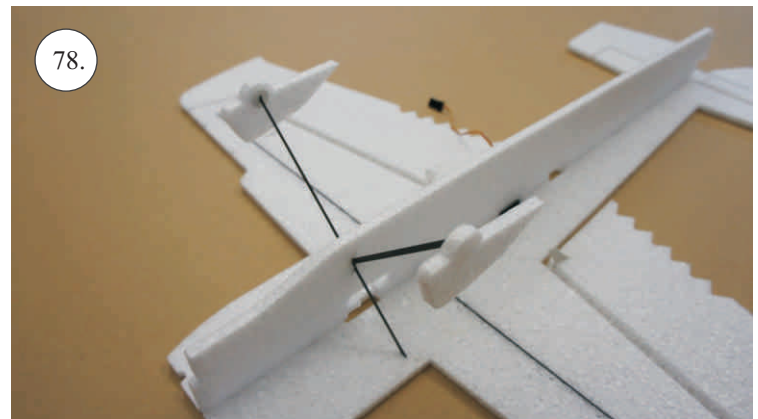
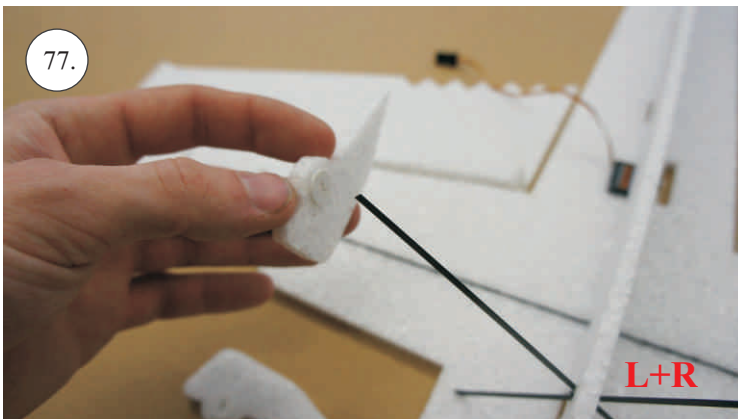
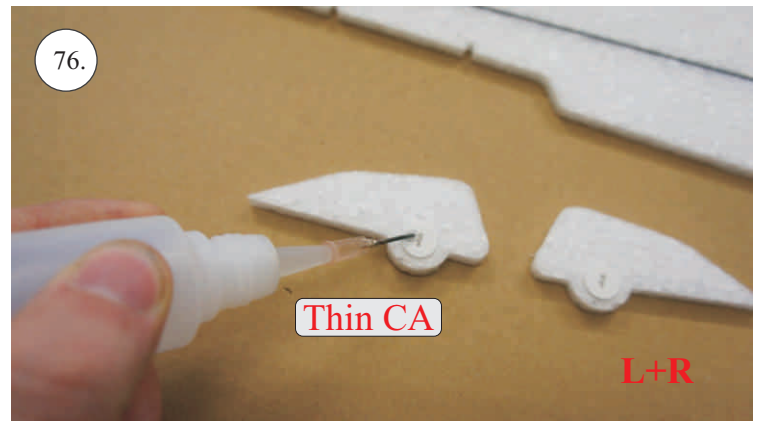
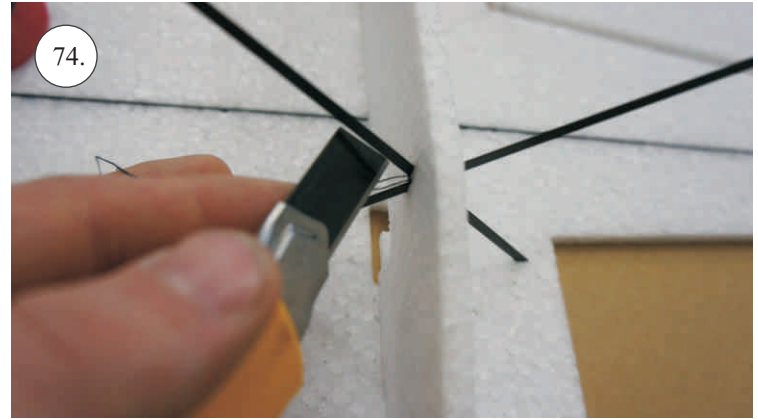
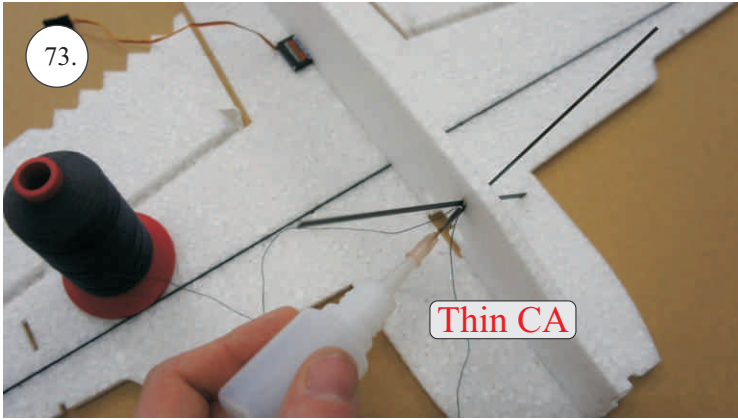
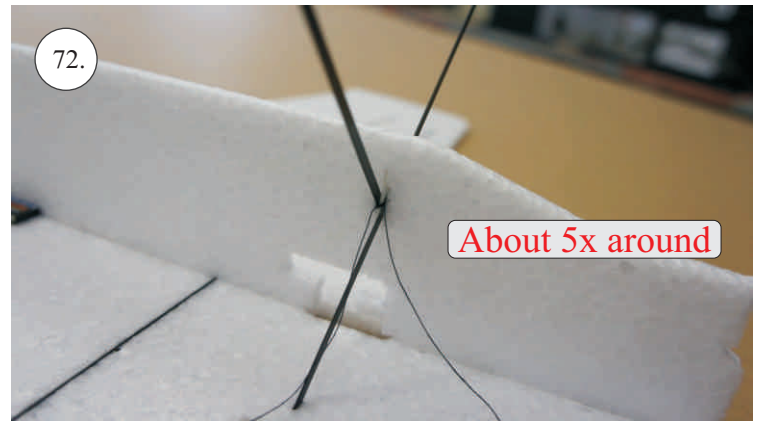
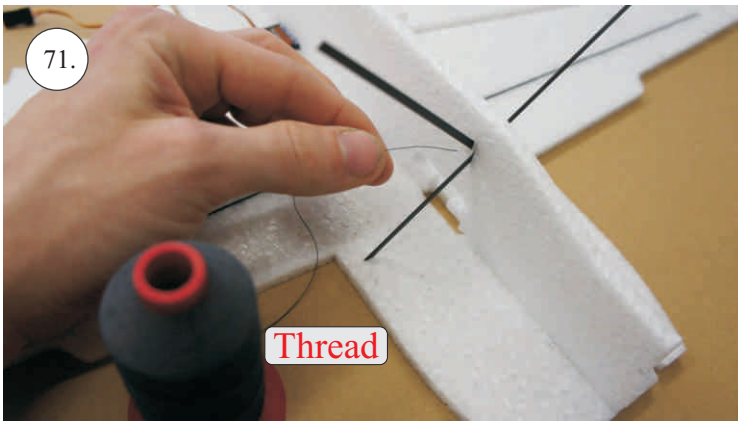

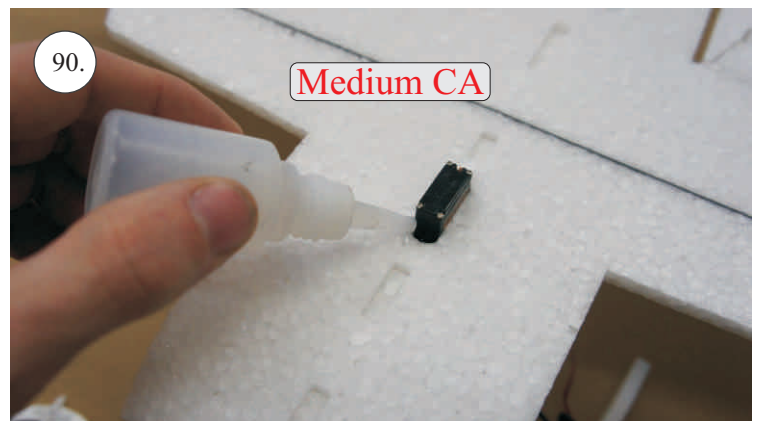
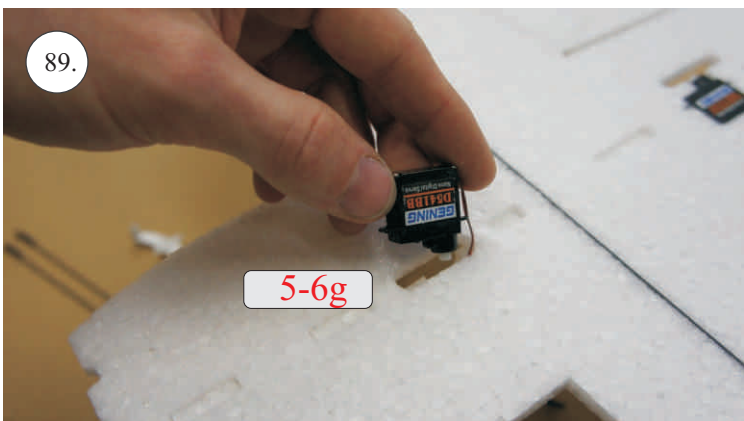
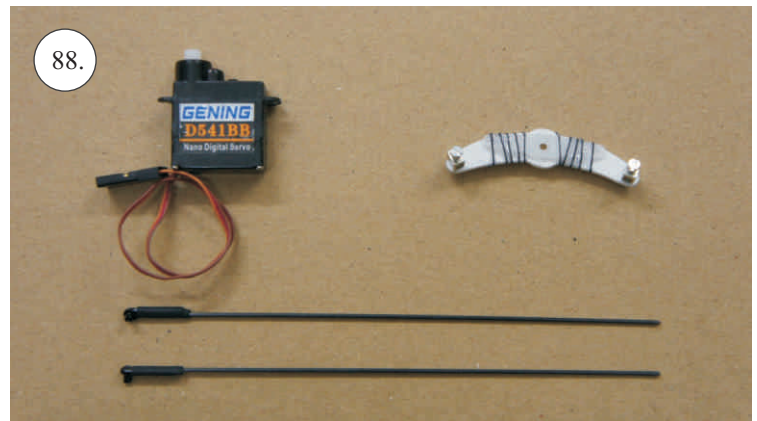
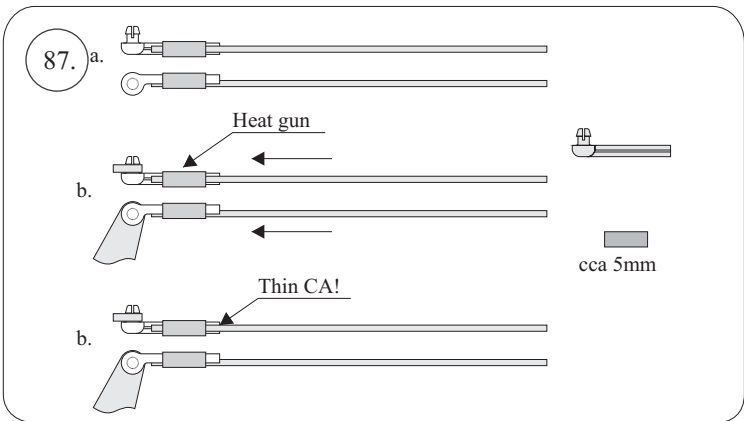
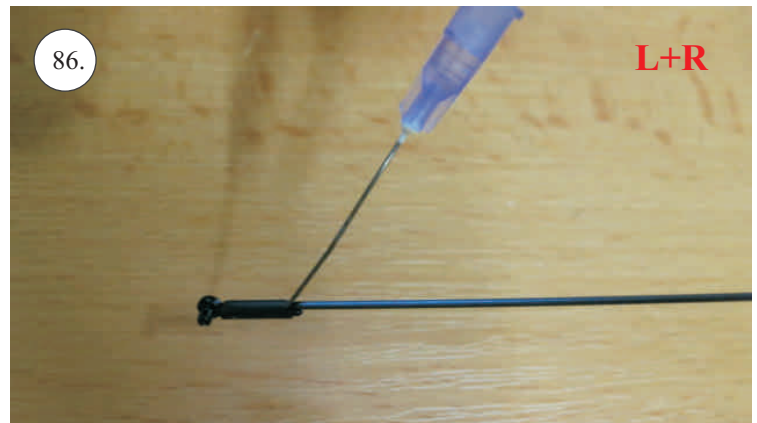
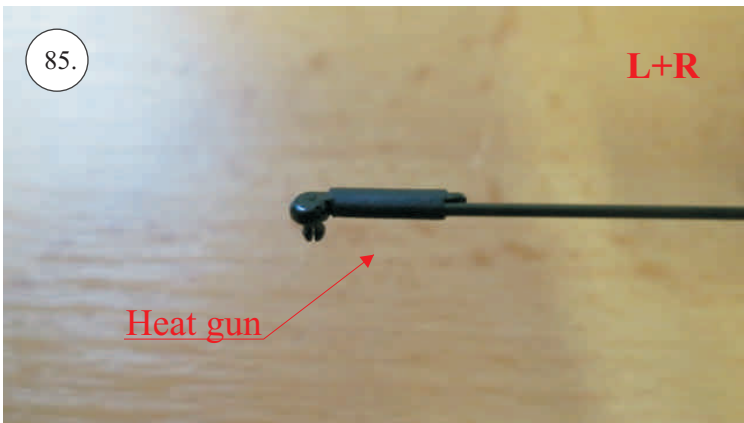
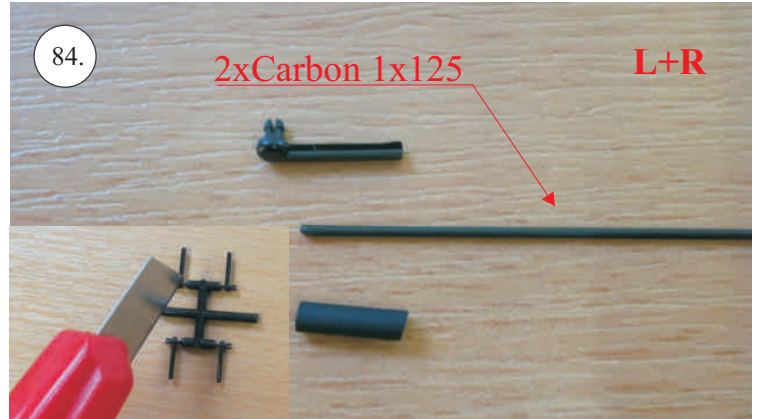
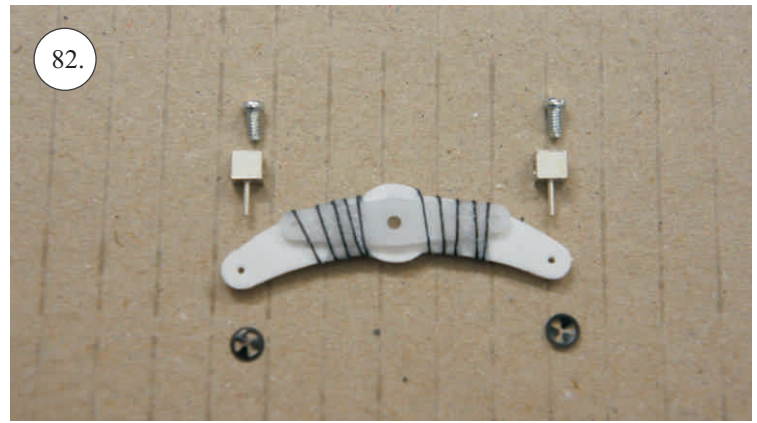
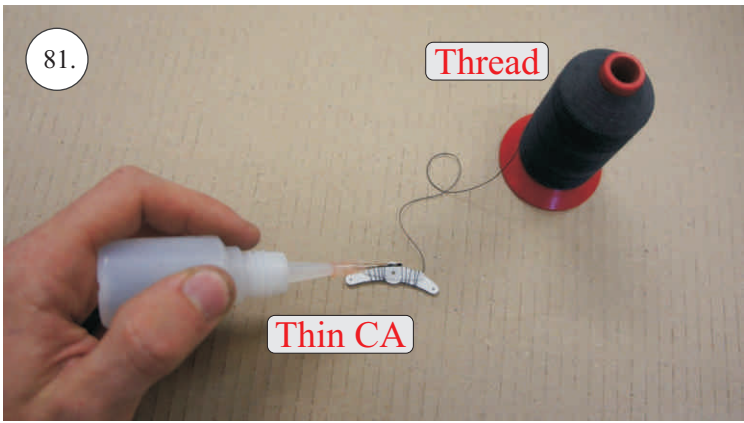

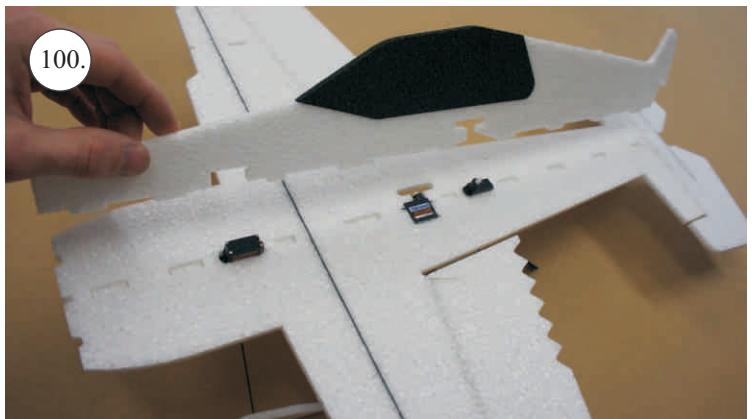
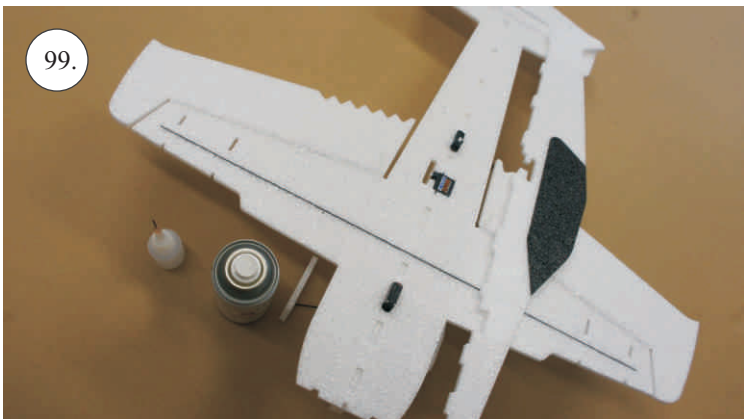
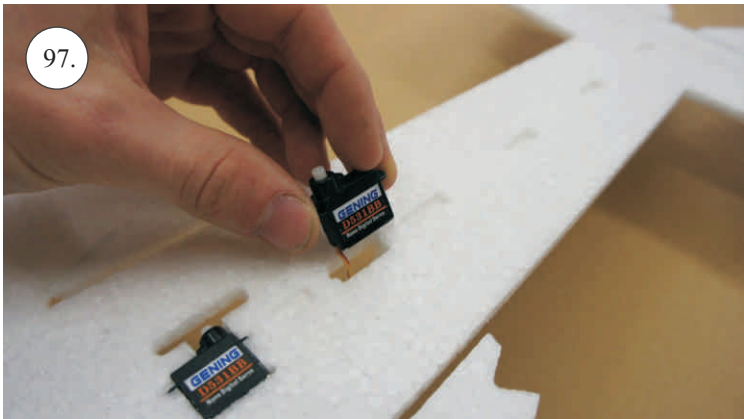
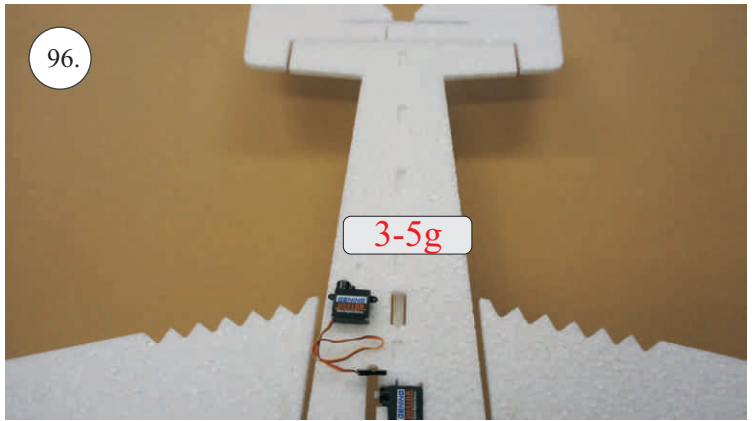
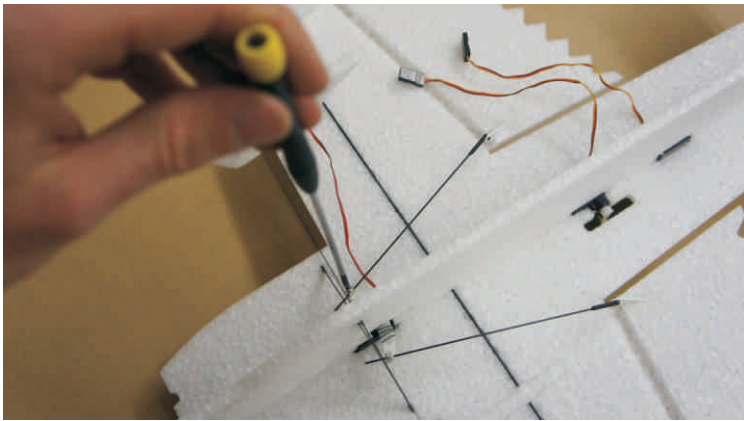
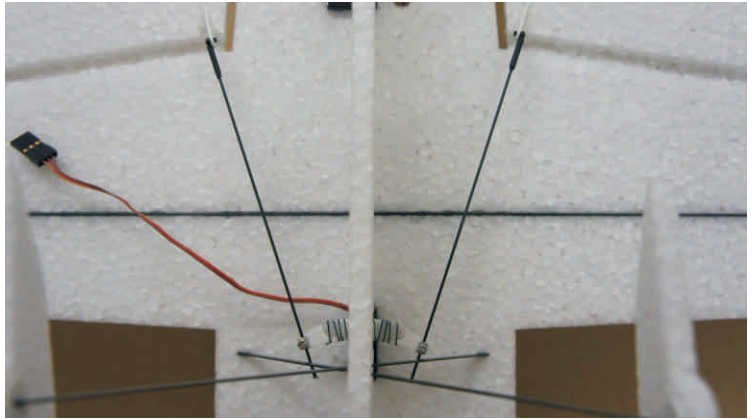
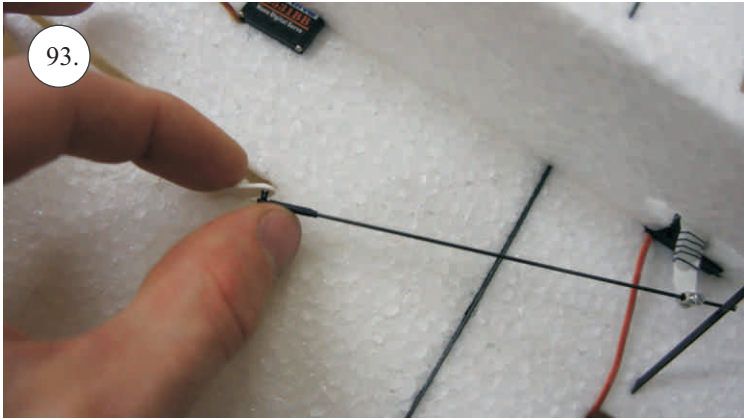
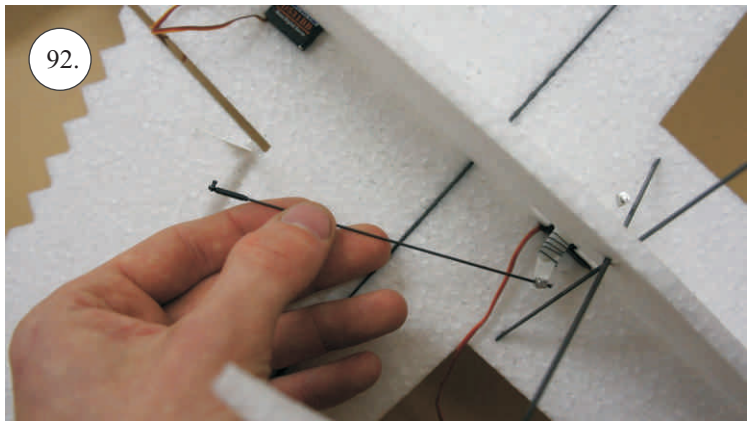
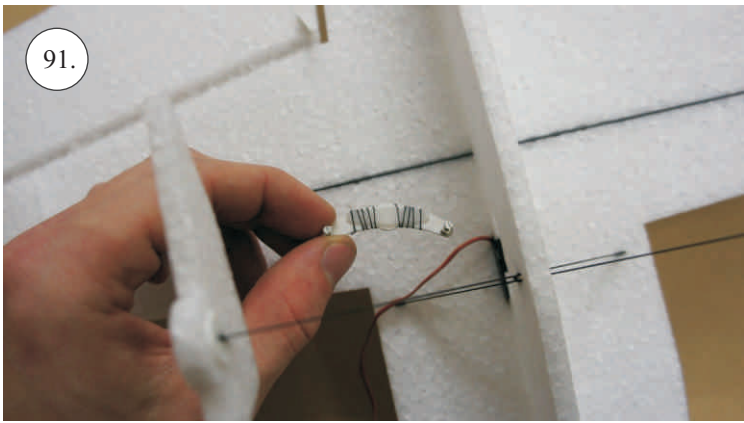

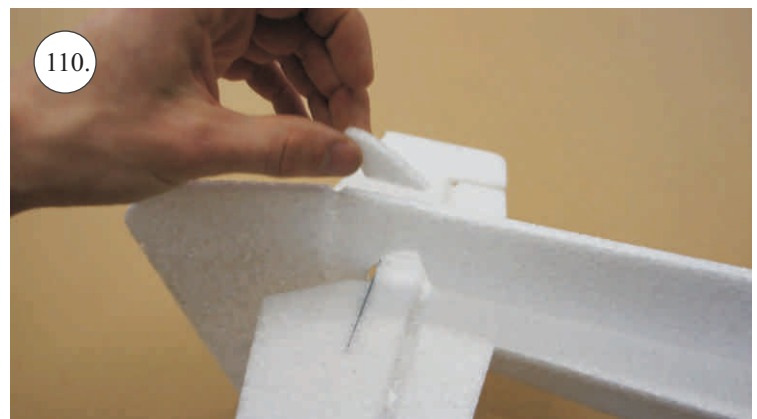
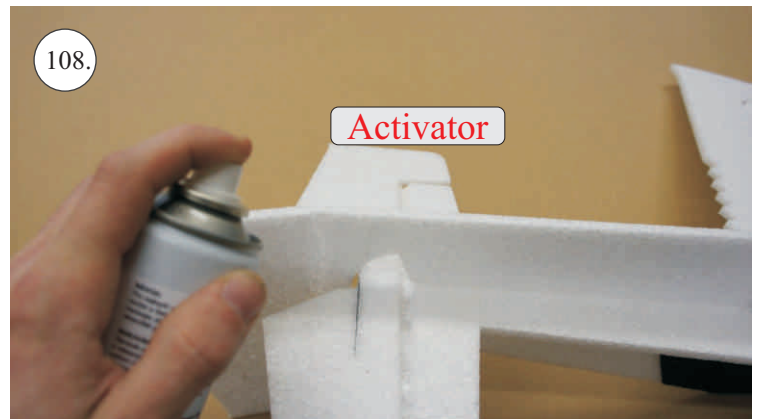
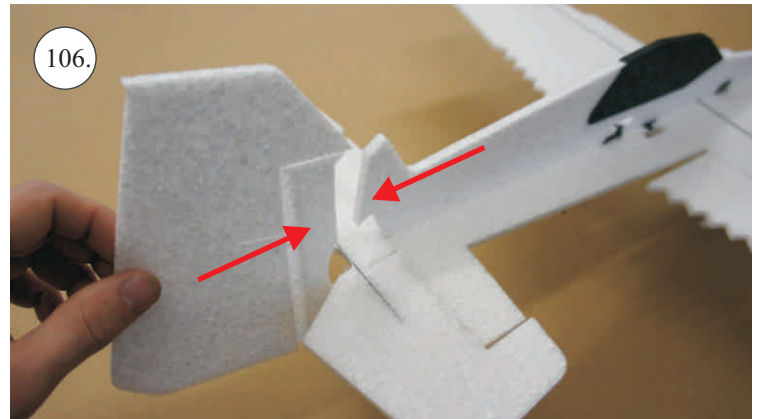
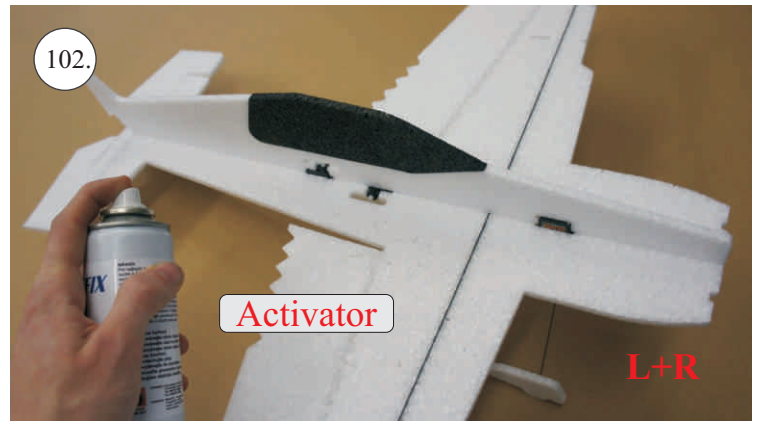
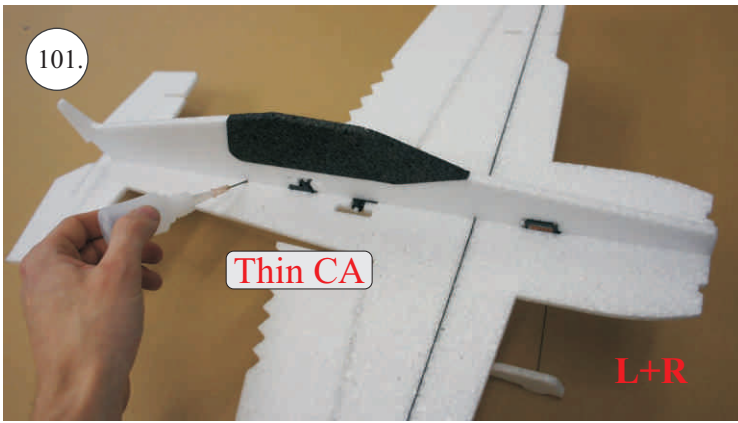

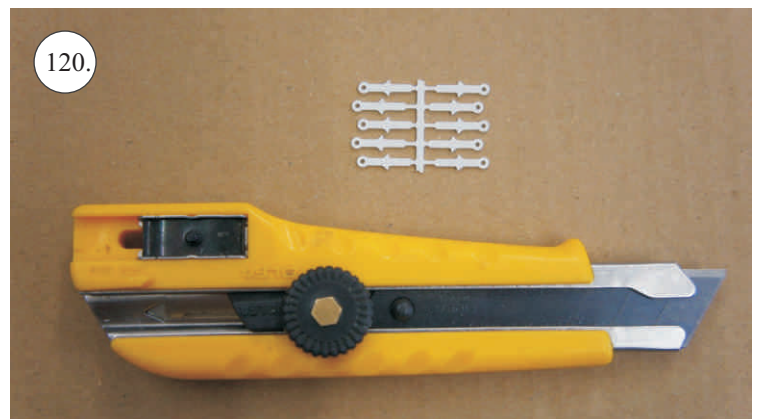
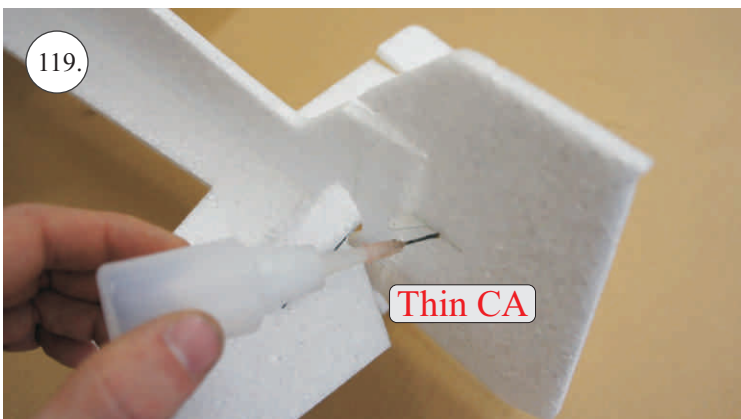
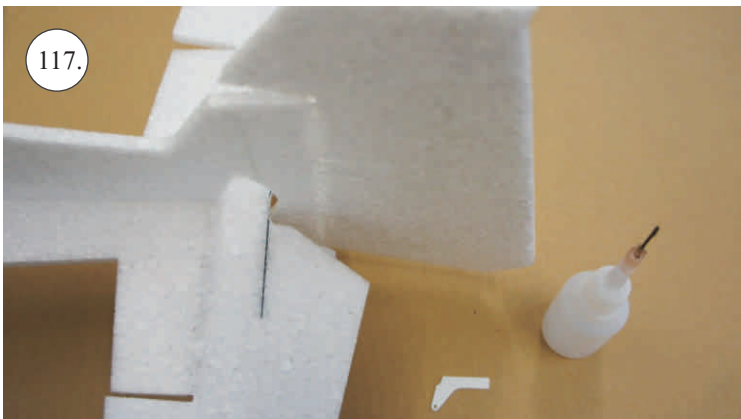
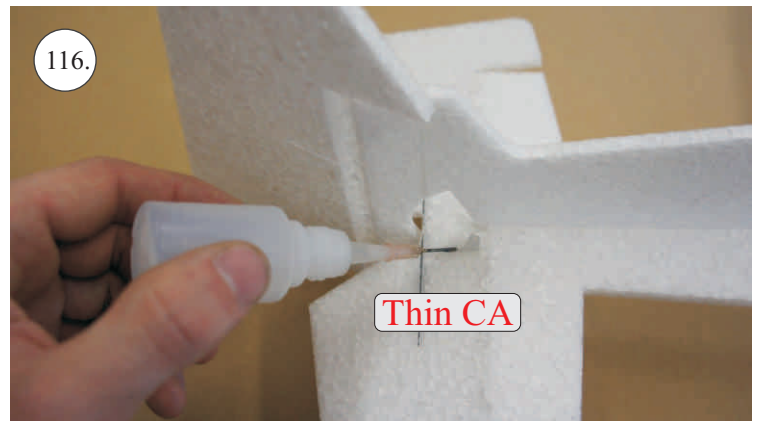
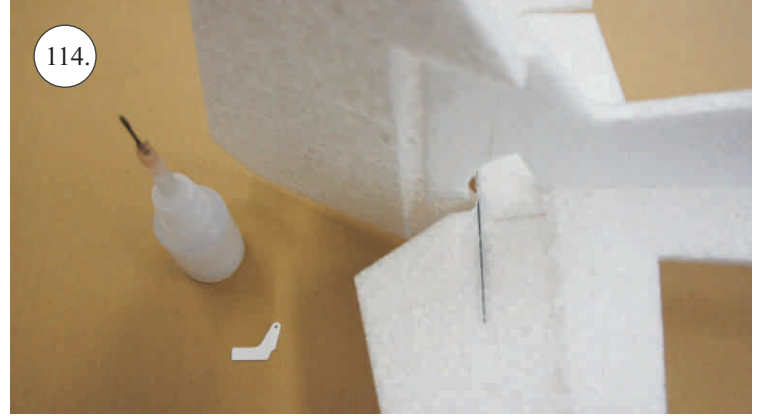
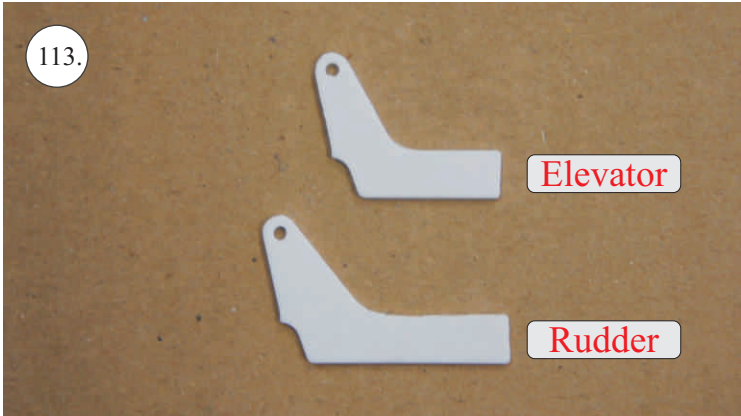
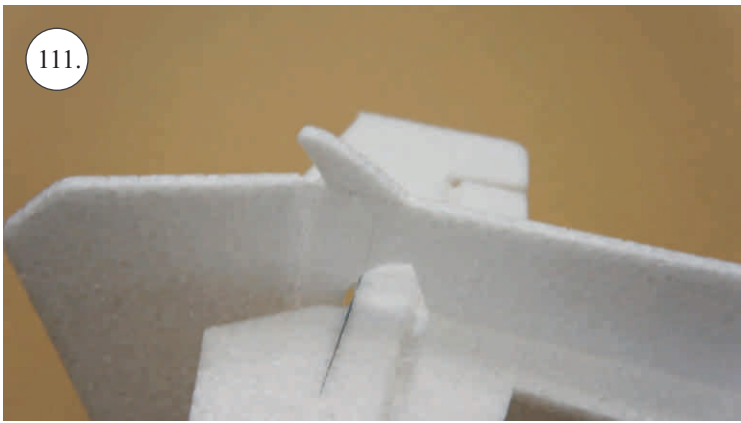

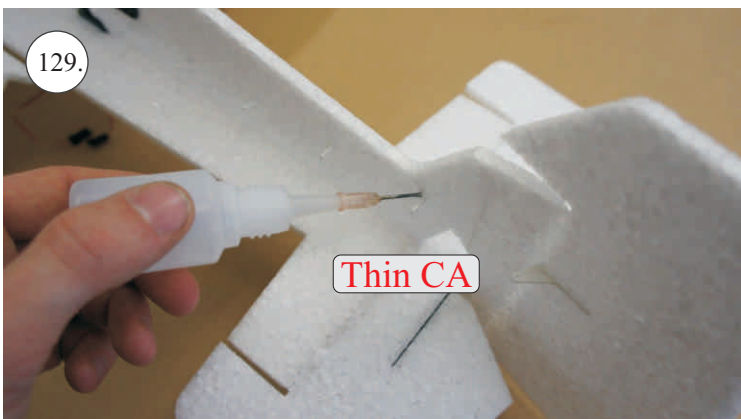
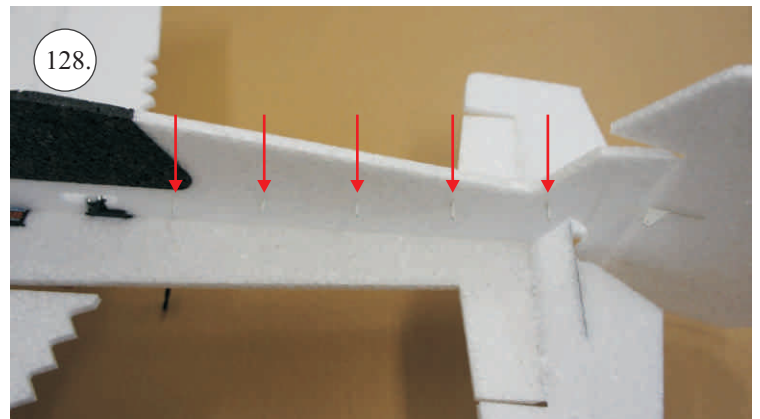
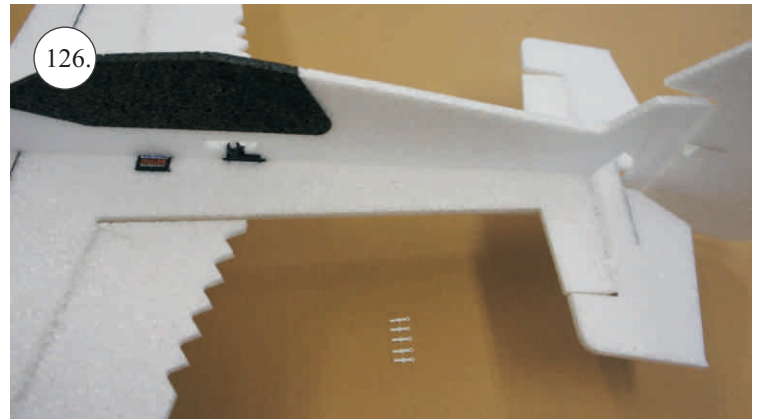
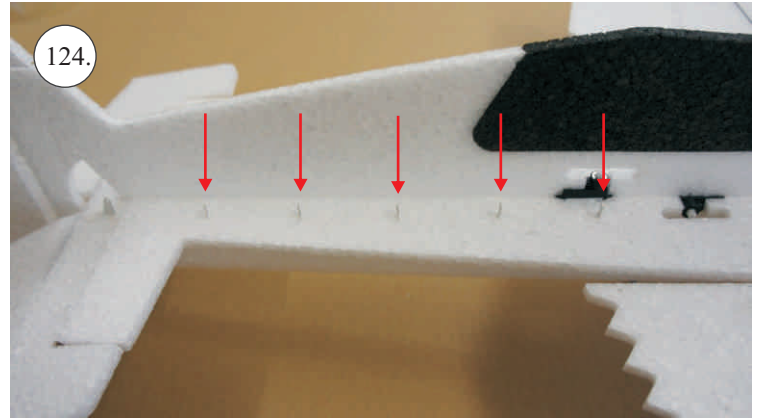
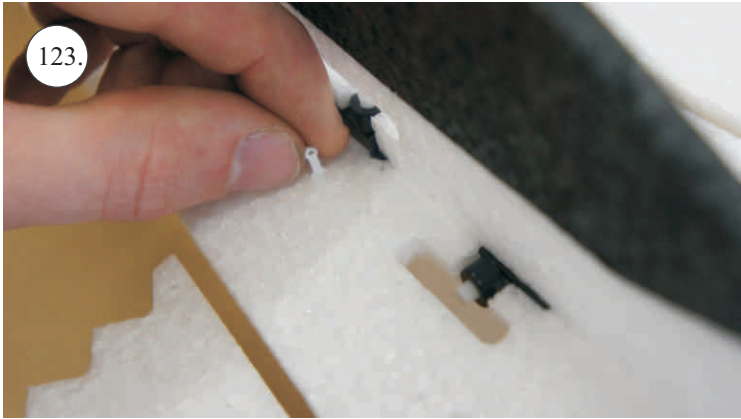
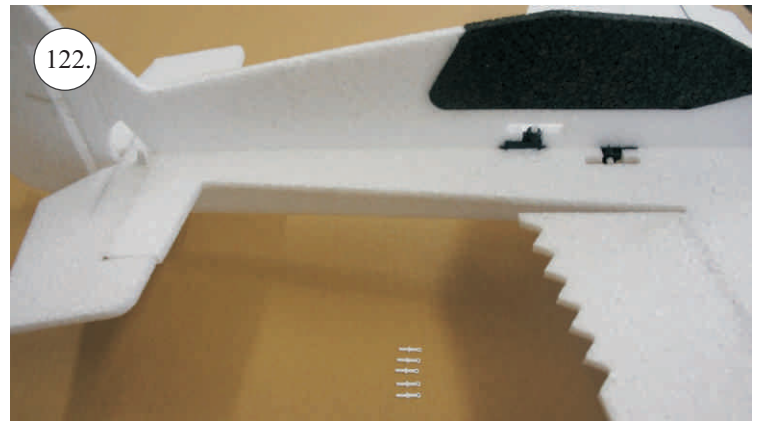
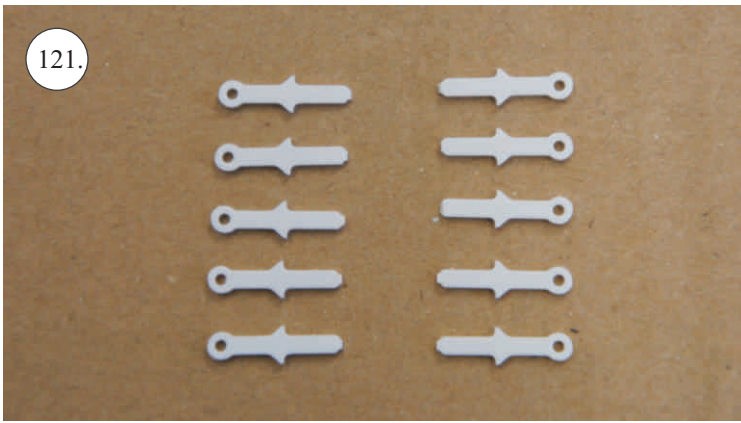

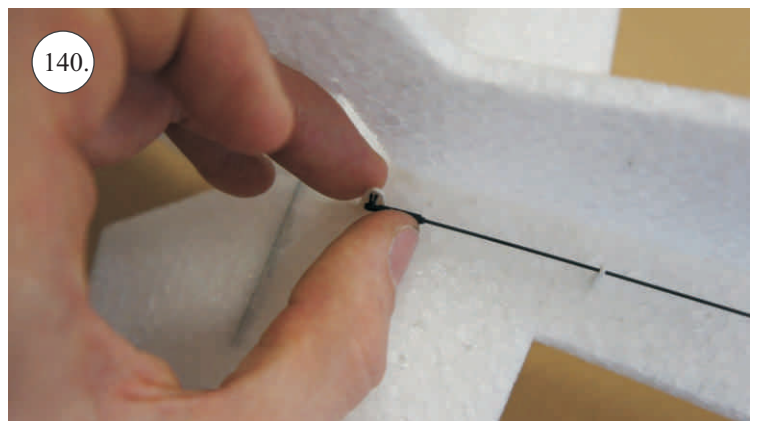
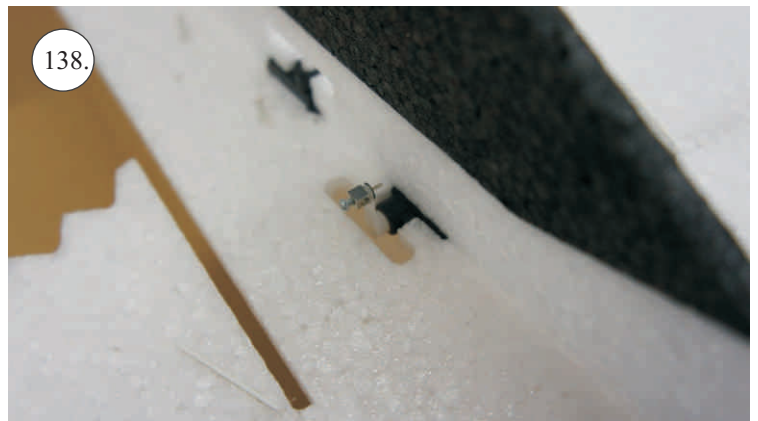
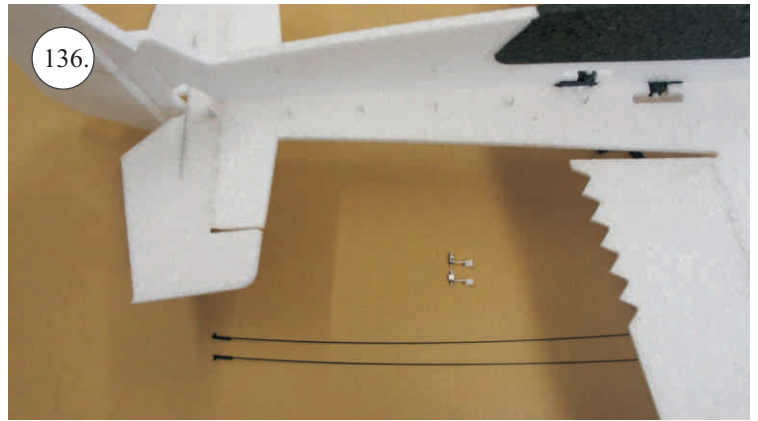
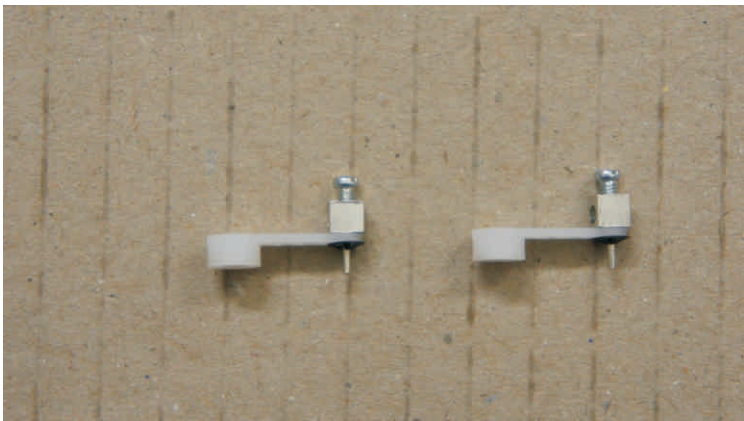
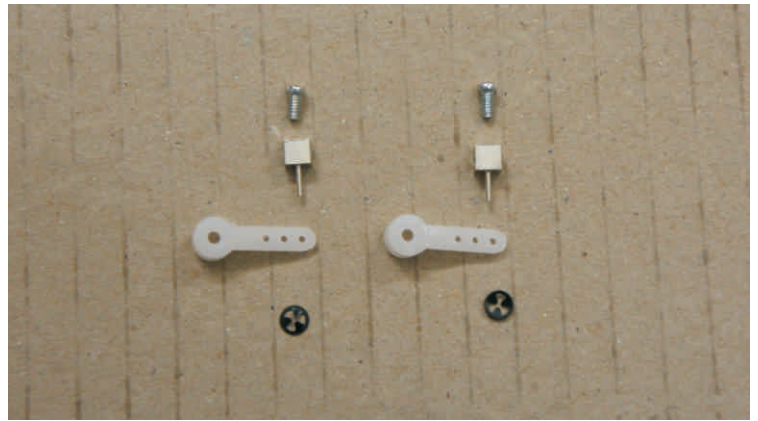
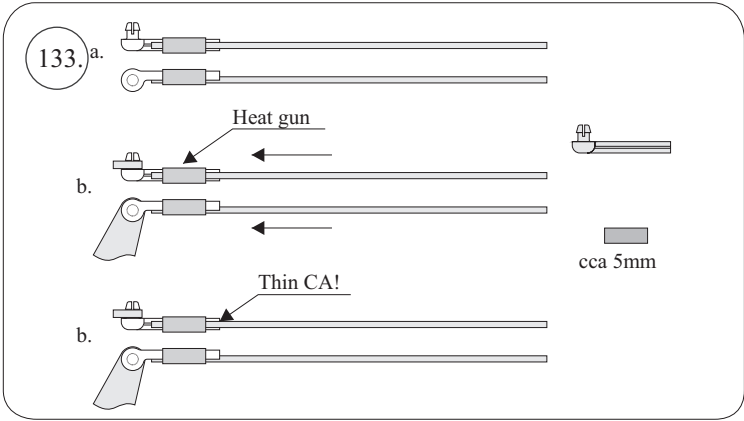
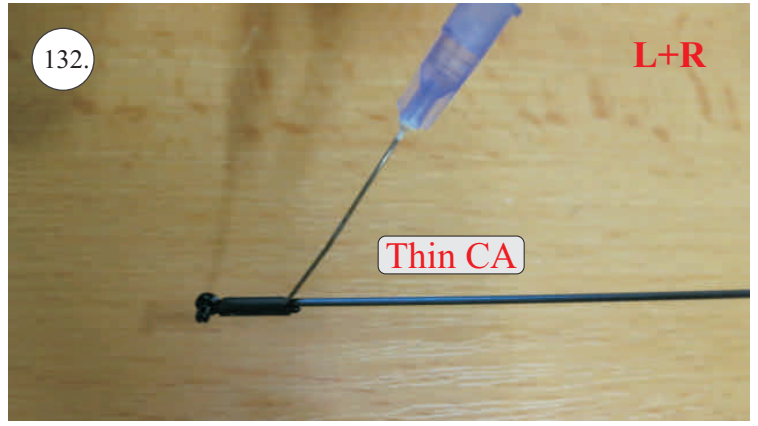

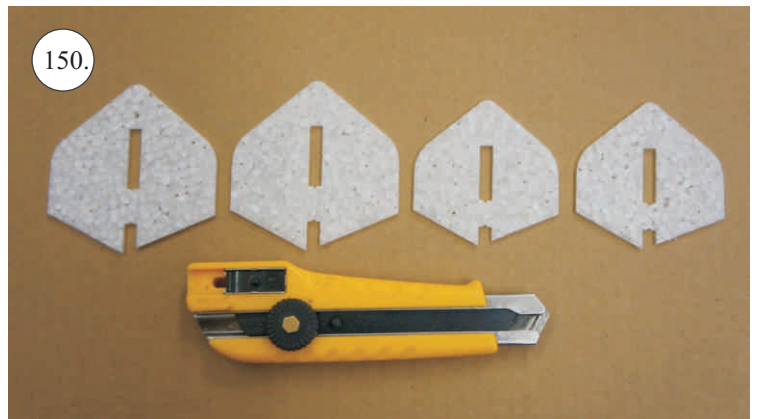
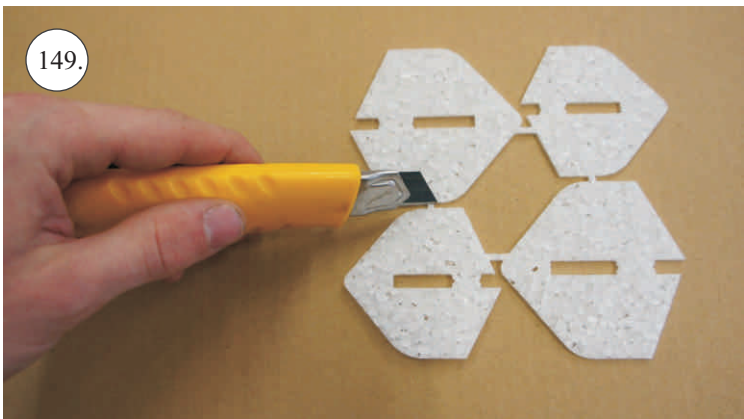
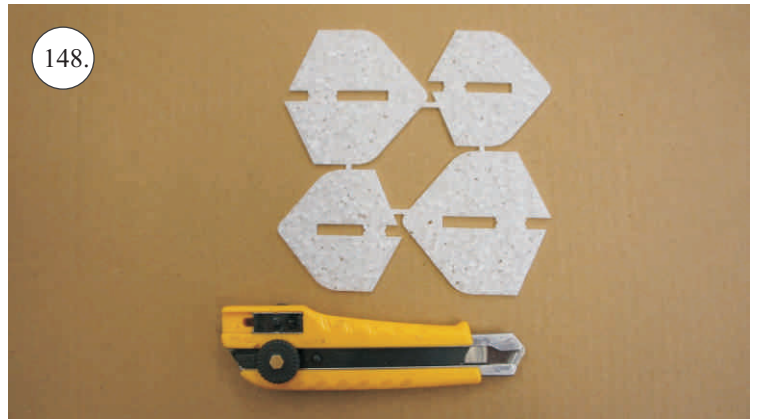
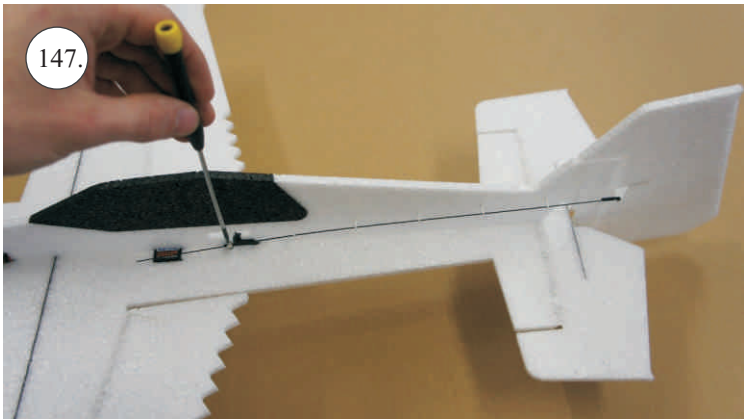
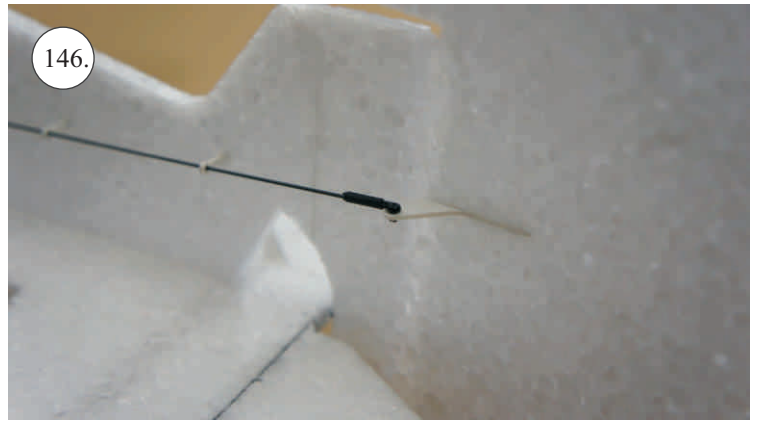
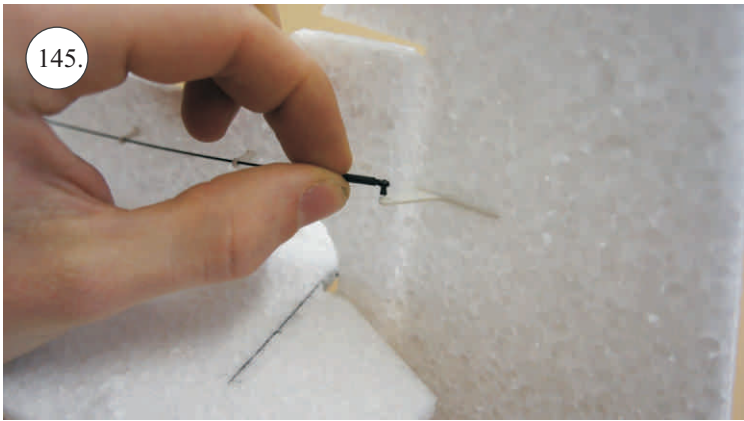
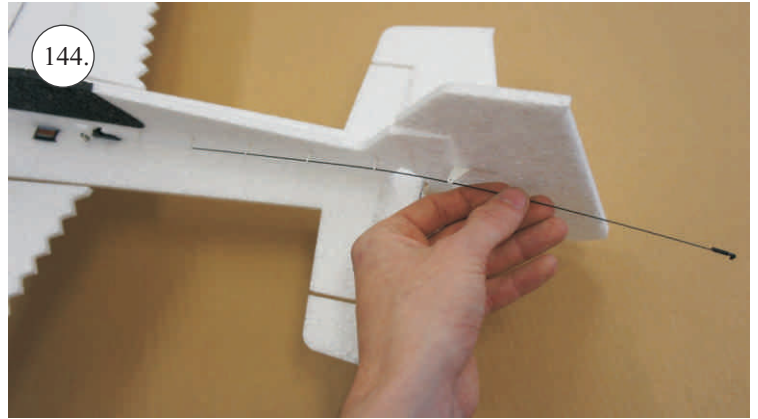
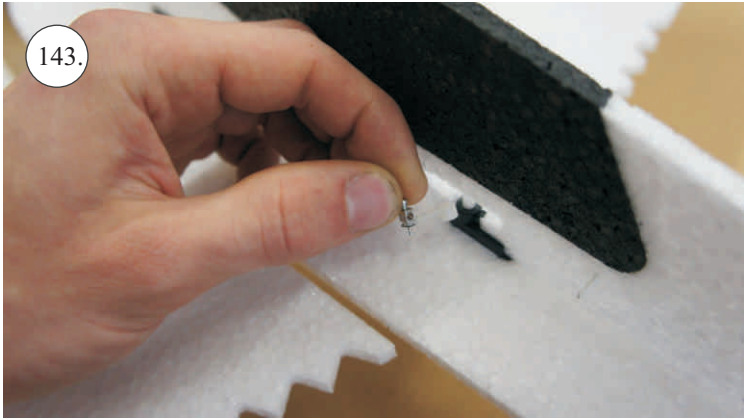
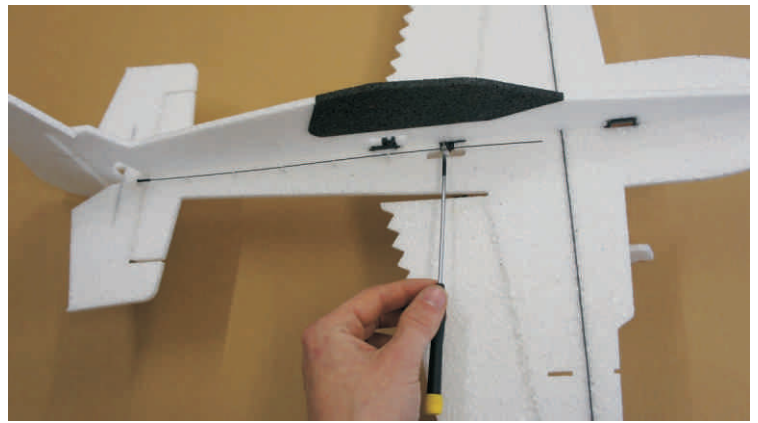
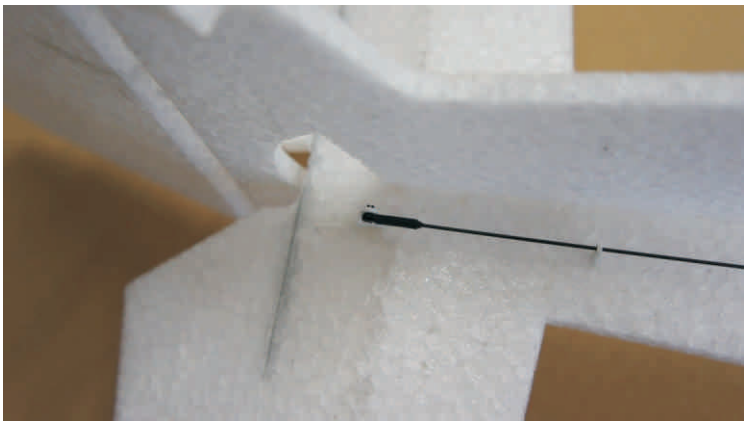

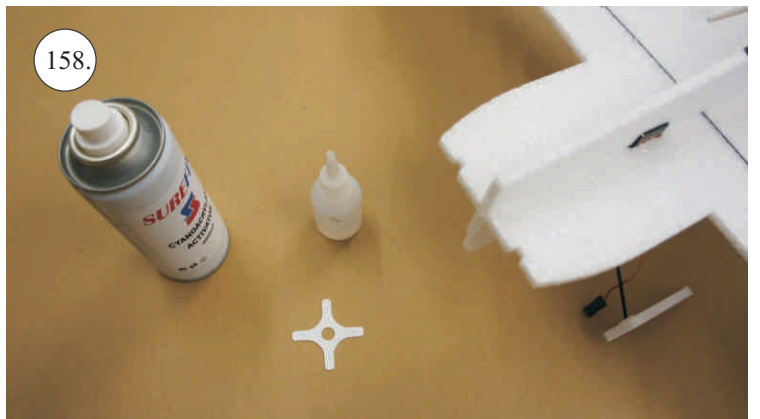
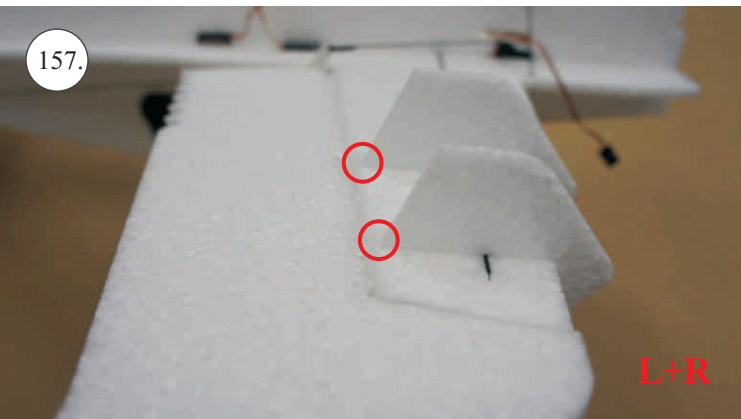
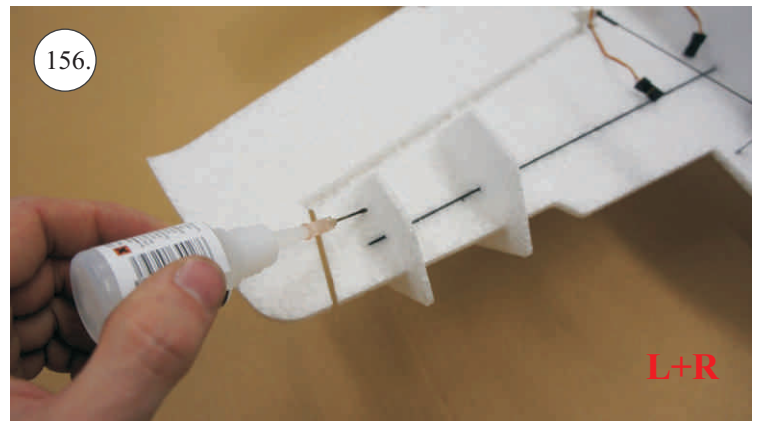
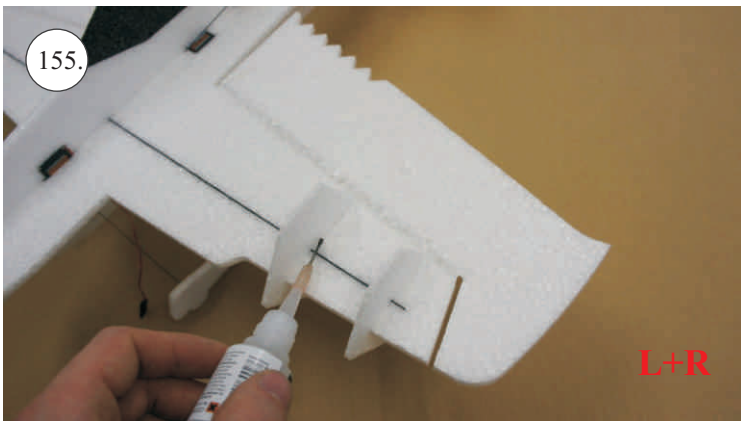
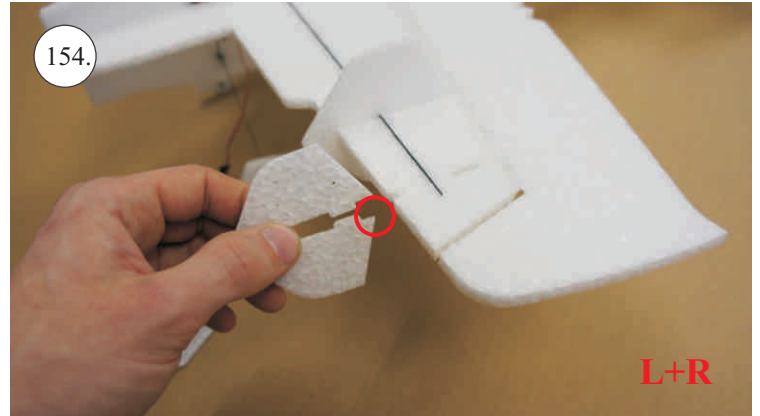
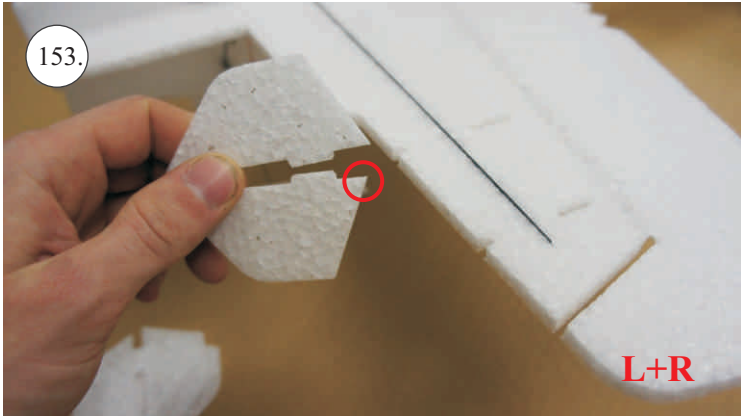
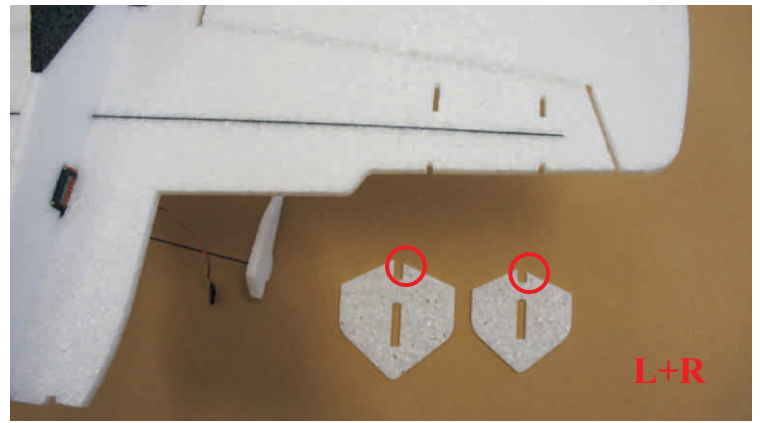
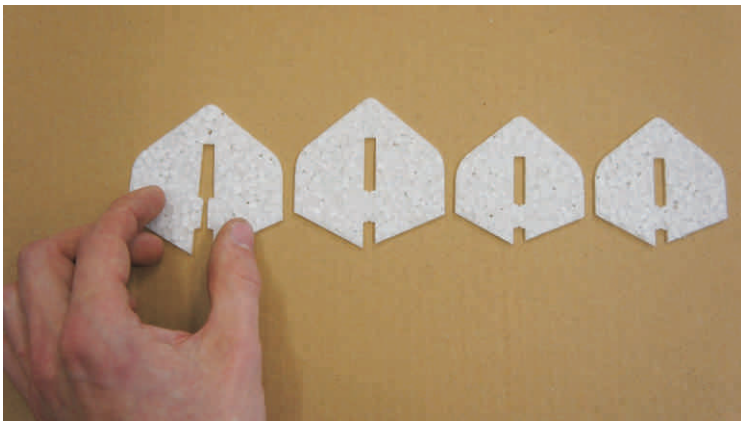

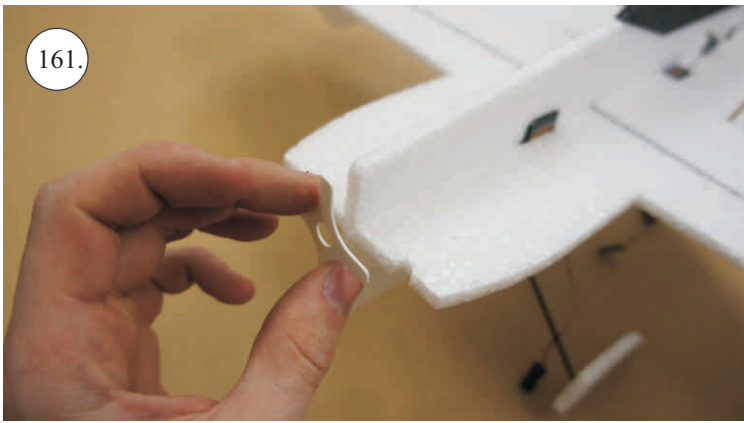

161.

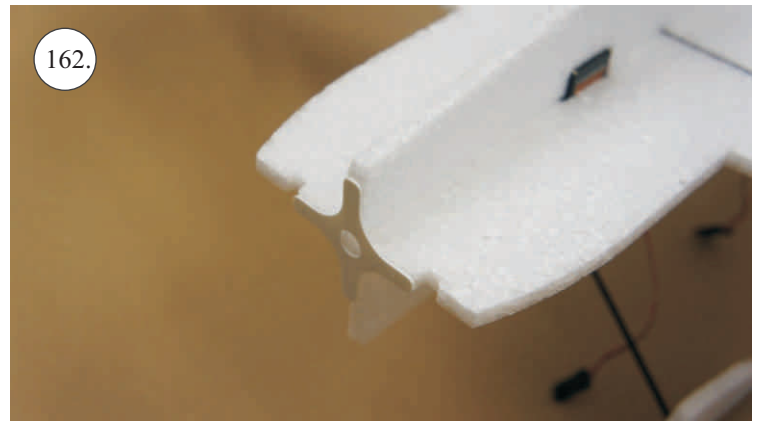

162.

Crack Yak mini

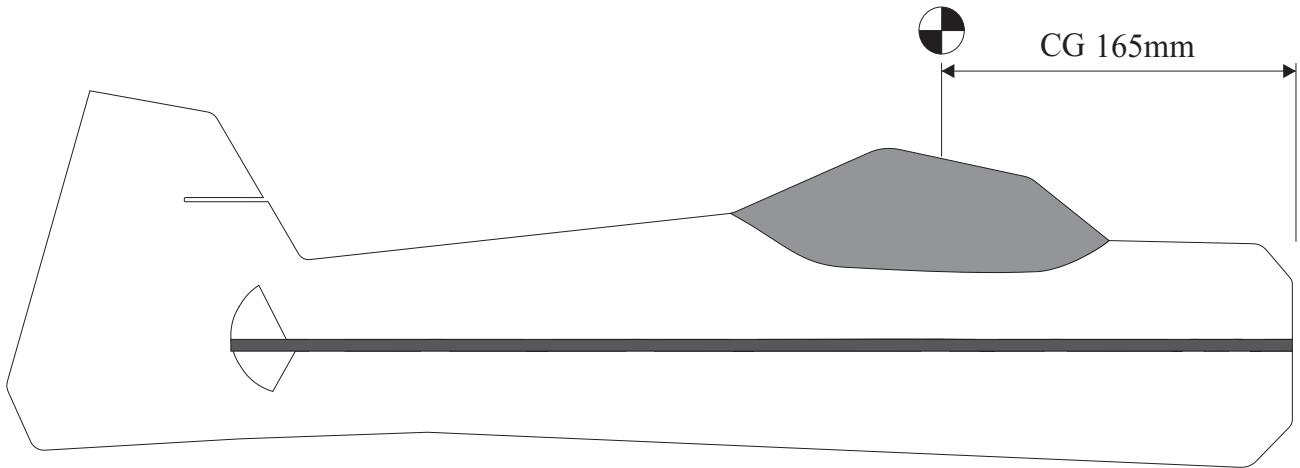

We wish you many happy flying hours with the Crack Yak mini.

Your RC Factory team

MXS-C mini

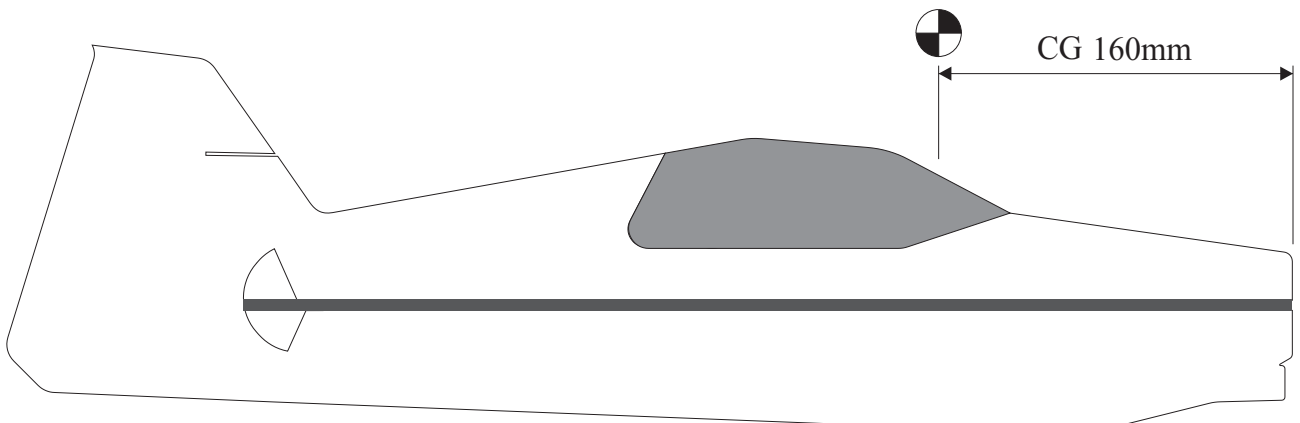

We wish you many happy flying hours with the MXS-C mini.

Your RC Factory team

Edge 540 mini

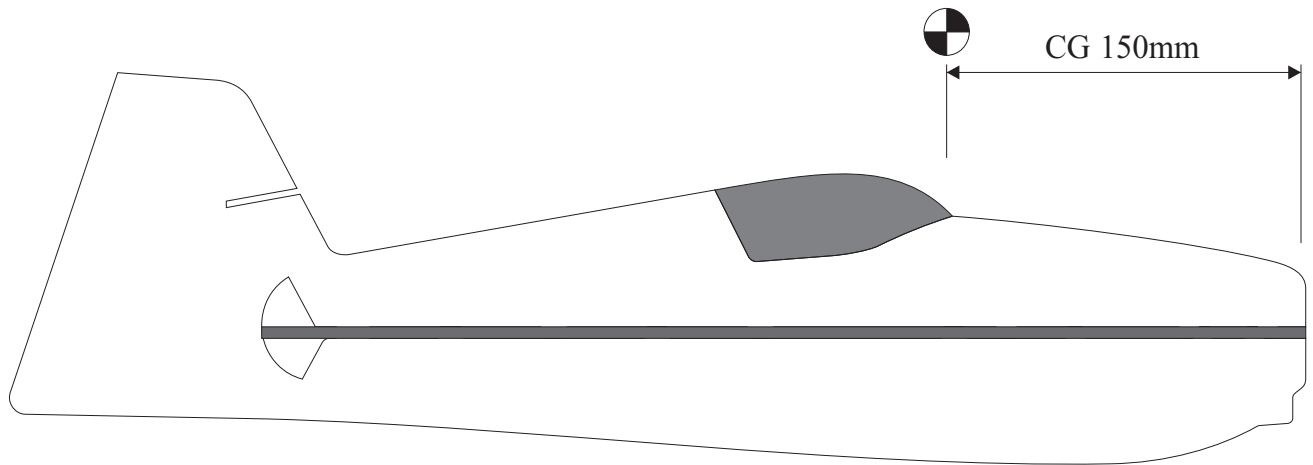

We wish you many happy flying hours with the Edge 540 mini.

Your RC Factory team